

9

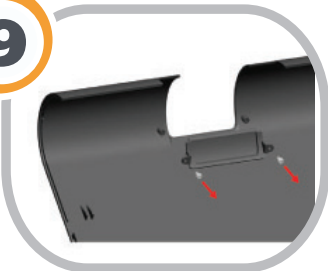

▶▶▶ Remove the screws.  
Remove the insert piece.

10

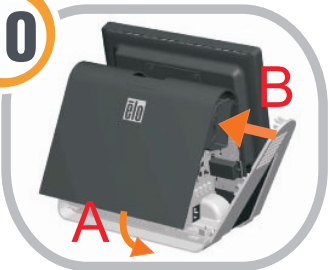

▶▶▶ Replace the back door (A),  
then replace the side door (B).

11

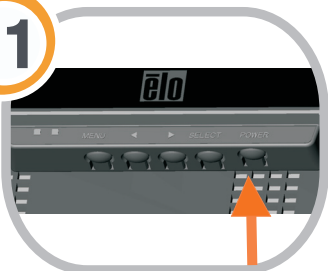

▶▶▶ Turn on the touchcomputer.

**Included Items:**

- Customer display module (includes pole assembly and cable with USB connector)
- Two screws to attach display module to chassis

Note: For the 15D1 touchcomputer, the software for the field-installable peripherals is already pre-installed.



# Quick Installation Guide

## Installing the Customer Display for the 15D1 Touchcomputer

Caution:  
Before attaching the customer display, make sure that the touchcomputer is powered off.

© 2009 Tyco Electronics.



[www.elotouch.com](http://www.elotouch.com)



Revision A  
P/N E861795

**North America**  
Elo TouchSystem  
301 Constitution Drive,  
Menlo Park, CA 94025  
[www.elotouch.com](http://www.elotouch.com)

**Elo Technical Support**  
**Online self-help:**  
[www.elotouch.com/go/websupport](http://www.elotouch.com/go/websupport)  
**Technical Support contacts in your region:**  
[www.elotouch.com/go/contactsupport](http://www.elotouch.com/go/contactsupport)

**Europe**  
Tel +32 (0)16 35 21 00  
Fax +32 (0)16 35 21 01  
[elosales@elotouch.com](mailto:elosales@elotouch.com)

**Asia-Pacific**  
Tel +81 (45) 478-2161  
Fax +81 (45) 478-2180  
[www.tps.co.jp](http://www.tps.co.jp)

**Latin America**  
Tel 1-305-428-5210  
Fax 1-305-717-4909  
[www.elotouch.com.ar](http://www.elotouch.com.ar)



**Tyco Electronics**

Our commitment. Your advantage.



▶▶▶ Turn off the power to the touchcomputer.



▶▶▶ Remove the side door, as shown.



▶▶▶ Remove the back door of the unit.



▶▶▶ Insert the hooks on the customer display into the holes in the panel.



▶▶▶ Push the display down.



▶▶▶ Add the screws.

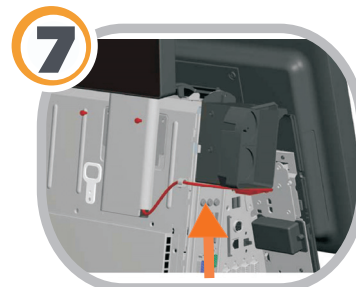

▶▶▶ Route the cable through the clip.



▶▶▶ Connect the cable to the USB connector marked with the display icon.

