

Included Items:

- MSR module
- One screw to attach MSR

Note: For the 15D1 touchcomputer, the software for the field-installable peripherals is already pre-installed.

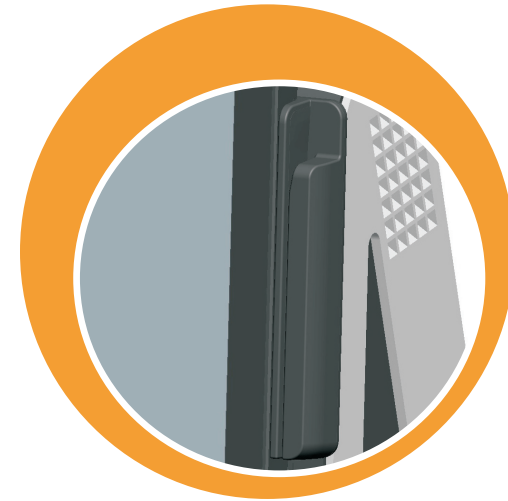

Quick Installation Guide

Installing the Magnetic Stripe Reader (MSR) for the 15D1 Touchcomputer

Caution:
Before attaching the MSR, make sure that the touchcomputer is powered off.



www.elotouch.com



Revision A
P/N E811209

North America
Elo TouchSystem
301 Constitution Drive,
Menlo Park, CA 94025
www.elotouch.com

Elo Technical Support
Online self-help:
www.elotouch.com/go/websupport
Technical Support contacts in your region:
www.elotouch.com/go/contactsupport

Europe
Tel +32 (0)16 35 21 00
Fax +32 (0)16 35 21 01
elosales@elotouch.com

Asia-Pacific
Tel +81 (45) 478-2161
Fax +81 (45) 478-2180
www.tps.co.jp

Latin America
Tel 1-305-428-5210
Fax 1-305-717-4909
www.elotouch.com.ar



Tyco Electronics

Our commitment. Your advantage.



www.elotouch.com



Revision A
P/N E811209

North America
Elo TouchSystem
301 Constitution Drive,
Menlo Park, CA 94025
www.elotouch.com

Elo Technical Support
Online self-help:
www.elotouch.com/go/websupport
Technical Support contacts in your region:
www.elotouch.com/go/contactsupport

Europe
Tel +32 (0)16 35 21 00
Fax +32 (0)16 35 21 01
elosales@elotouch.com

Asia-Pacific
Tel +81 (45) 478-2161
Fax +81 (45) 478-2180
www.tps.co.jp

Latin America
Tel 1-305-428-5210
Fax 1-305-717-4909
www.elotouch.com.ar



Tyco Electronics

Our commitment. Your advantage.

1

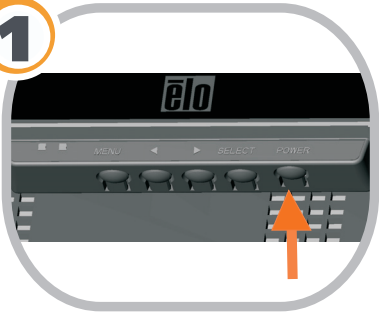

▶▶▶ Turn off the power to the touchcomputer.

2



▶▶▶ Remove the existing cover for the MSR port on the back side of the display head.

3



▶▶▶ Connect the MSR to the existing connector (USB).

4

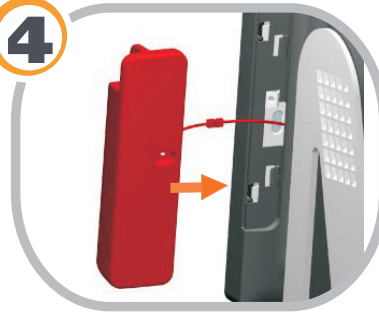

▶▶▶ Slide the MSR onto the mounting hooks.

5

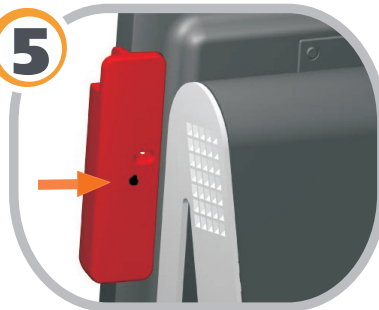

▶▶▶ Secure the MSR onto the display head with one screw from the MSR Kit.

6



▶▶▶ Turn on the touchcomputer.