

9

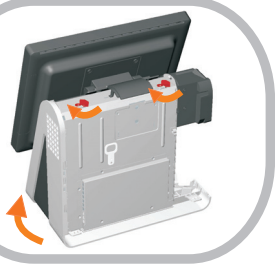

▶▶▶ Replace the door and pivot the latches to lock it.

10

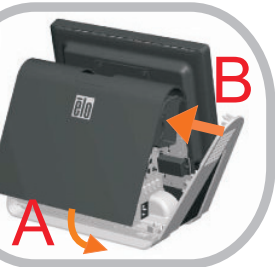

▶▶▶ Replace the back door (A), then replace the side door (B).

11



▶▶▶ Turn on the touchcomputer.

Included Items:

- Wireless module (including PCI to mini-PCI converter board)
- Antenna
- Two screws to mount wireless module
- Two screws to mount antenna

Note: For the 15D1 touchcomputer, the software for the field-installable peripherals is already pre-installed.



Quick Installation Guide

Installing the Wireless Card for the 15D1 Touchcomputer

Caution:
Before installing the wireless card, make sure that the touchcomputer is powered off.

© 2009 Tyco Electronics.



www.elotouch.com



Revision A
P/N E611247

North America
Elo TouchSystem
301 Constitution Drive,
Menlo Park, CA 94025
www.elotouch.com

Elo Technical Support
Online self-help:
www.elotouch.com/go/websupport
Technical Support contacts in your region:
www.elotouch.com/go/contactsupport

Europe
Tel +32 (0)16 35 21 00
Fax +32 (0)16 35 21 01
elosales@elotouch.com

Asia-Pacific
Tel +81 (45) 478-2161
Fax +81 (45) 478-2180
www.tps.co.jp

Latin America
Tel 1-305-428-5210
Fax 1-305-717-4909
www.elotouch.com.ar



Tyco Electronics

Our commitment. Your advantage.



▶▶▶ Turn off the power to the touchcomputer.



▶▶▶ Remove the side door, as shown.



▶▶▶ Remove the back door of the unit.



▶▶▶ Pivot the latches to unlock the door, then lift up on the tab to remove the door.



▶▶▶ Add wireless module to top PCI connector.

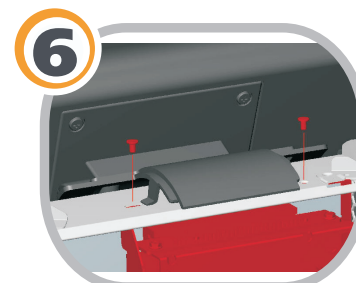

▶▶▶ Secure wireless card module with 2 screws.

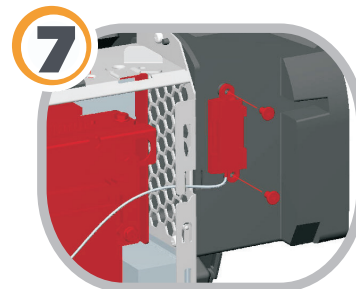

▶▶▶ Add antenna and secure with screws.

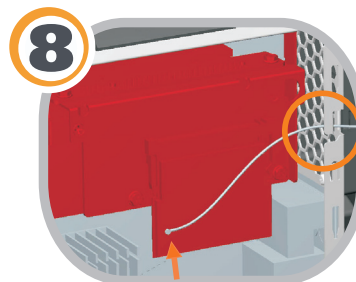

▶▶▶ Route the antenna wire through the slot in the frame. Attach the wire to the primary connector on the wireless card.