



Quick Installation Guide

1520 15" All-in-One Touchcomputer

1 CABLE CONNECTIONS:
For easiest access, place monitor screen-side down (place on soft cloth to prevent scratches). Remove two security screws with Alan wrench (tool provided) and slide cover off.



3 After all appropriate cables are attached, turn on power to the Touchcomputer. Make changes to the screen image with the on-screen buttons (see below).

2 After cables are attached to the Touchcomputer, slide cover on and route cables through the opening in the cable cover. Re-install security screws.

ON-SCREEN DISPLAY BUTTONS

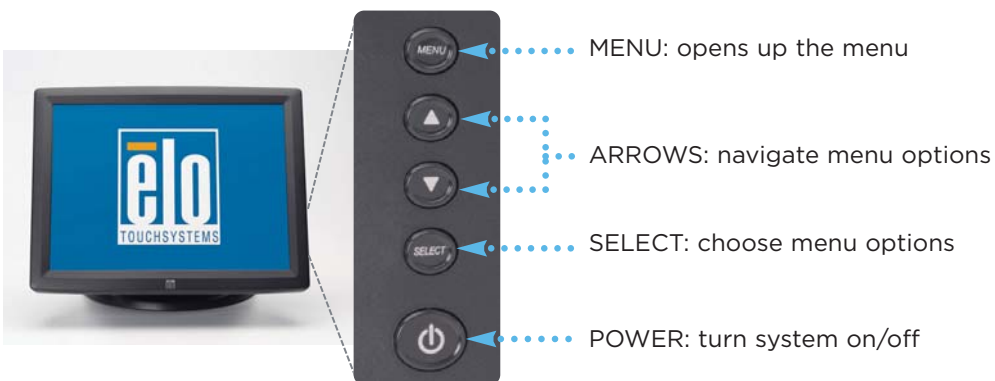

THE 1520 15" TOUCHCOMPUTER when combined with an operating system operates as a standard PC. Touch the screen to navigate, no mouse is required.

1520 15" All-in-One Touchcomputer

Acoustic Pulse Recognition (APR) Touchcomputer

INSET: With factory-installed video and audio cables.

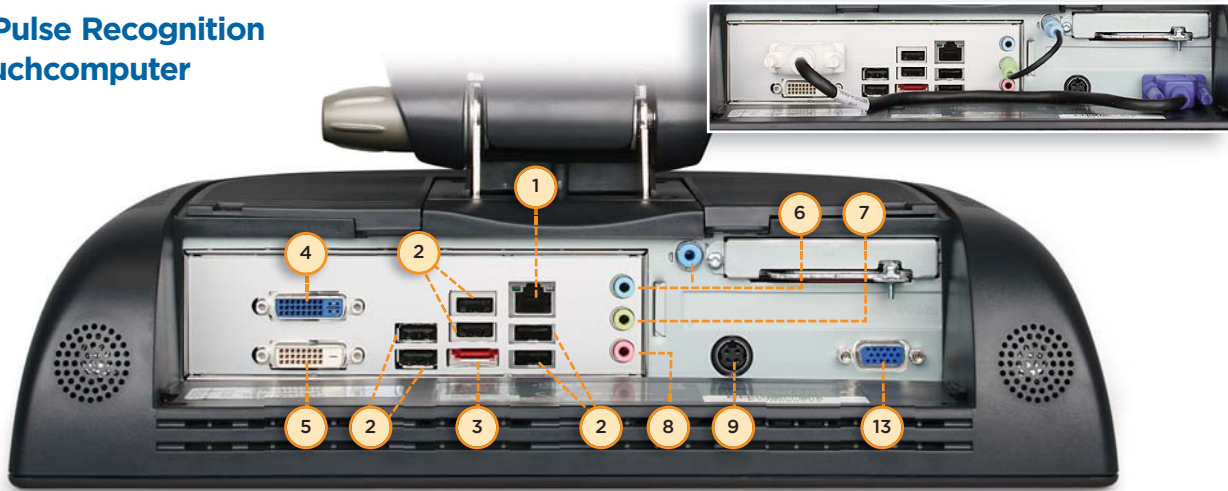

- | | | | | |
|------------------|-----------------|---------------|--------------------|---------|
| 1. Ethernet port | 4. DVI-I | 7. Audio Out | 10. Mouse/Keyboard | 13. VGA |
| 2. USB ports | 5. DVI-D | 8. Microphone | 11. Parallel port | |
| 3. ESATA | 6. Audio In (2) | 9. 12V Input | 12. Serial port | |

AccuTouch & IntelliTouch Touchcomputer

INSET: With factory-installed video and audio cables.

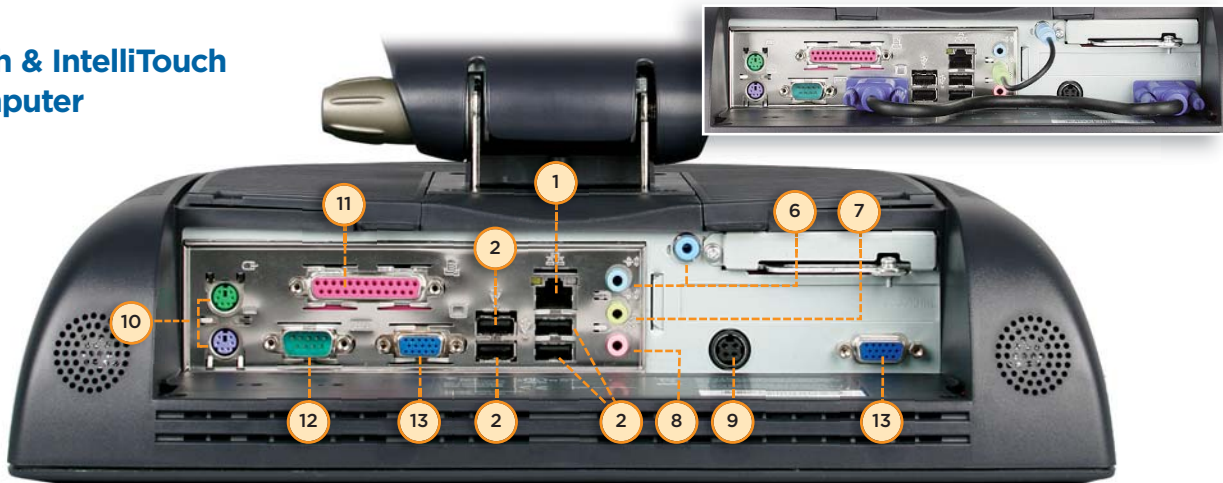

<p>For the complete User Manual for this product, visit: www.elotouch.com/Support/Documentation/manuals.asp</p>	<p>For current Elo news, product updates and announcements, register to receive our TouchMonitor newsletter at: www.elotouch.com/go/news</p>
---	---

Elo Technical Support:

Technical Information: www.elotouch.com/go/websupport • Worldwide Technical Support: www.elotouch.com/go/contactsupport
 North America: Website: www.elotouch.com Tel: 800-557-1458 (toll free) or 650-361-4800

Tyco Electronics Corporation and its Affiliates in the TE Touch Solutions business unit of the TE Connectivity Ltd. family of companies (collectively "TE") reserves the right to change or update, without notice, any information contained herein; to change, without notice, the design, construction, materials, processing or specifications of any products; and to discontinue or limit production or distribution of any products. Elo (logo), Elo TouchSystems, TE Connectivity, TE connectivity (logo) and TE (logo) are trademarks of the TE Connectivity Ltd. family of companies. Copyright 2011 Tyco Electronics Corporation, a TE Connectivity Ltd. Company. All rights reserved. 05/11 • PN: E096444 Rev.A



www.elotouch.com

