



17A2



1 Turn off power to the touchcomputer and unplug the power adapter from the unit.



2 Carefully place the touchcomputer facedown on a soft, flat surface. Turn touchcomputer upside down and take off the back cover insert.

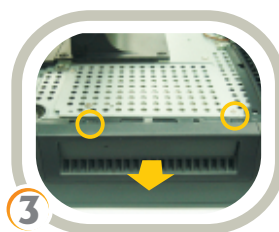

3 Remove the two screws attaching the DVD drive flap and remove the flap.

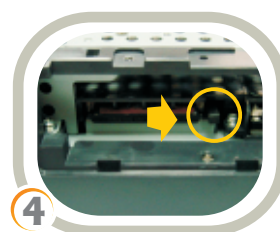

4 If you have an existing CF card, press the black eject button to remove it.

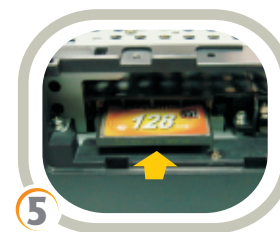

5 Insert the CF card into the slot. If inserted correctly, the black eject button should click and come out.

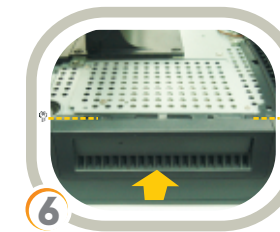

6 Close the flap and replace the two screws removed in Step 3.



7 Replace the back cover insert.



8 Reconnect the power adapter and power on the touchcomputer. You may use the operating system to verify that the CF card is installed properly.

15A2



1 Turn off power to the touchcomputer and unplug the power adapter from the unit.



2 Carefully place the touchcomputer facedown on a soft, flat surface. Turn touchcomputer upside down and take off the back cover insert.

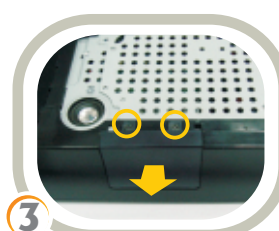

3 Remove the two screws attaching the CF door flap and remove the flap.

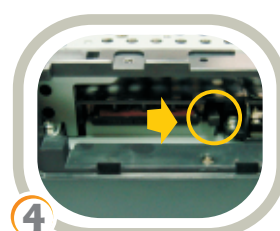

4 If you have an existing CF card, press the black eject button to remove it.



5 Insert the CF card into the slot. If inserted correctly, the black eject button should click and come out.

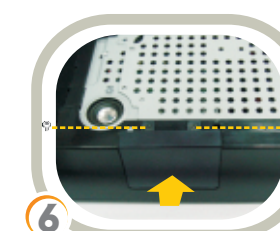

6 Close the flap and replace the two screws removed in Step 3.



7 Replace the back cover insert.



8 Reconnect the power adapter and power on the touchcomputer. You may use the operating system to verify that the CF card is installed properly.

Quick Installation Guide

Installing the CF Card for the 17A2/15A2



www.elotouch.com

North America
Elo TouchSystems
301 Constitution Drive,
Menlo Park, CA 94025
www.elotouch.com

Elo Technical Support
Online self-help:
www.elotouch.com/go/websupport
Technical Support contacts in your region:
www.elotouch.com/go/contactsupport

Europe
Tel +32 (0)16 35 21 00
Fax +32 (0)16 35 21 01
elosales@elotouch.com

Asia-Pacific
Tel +81 (45) 478-2161
Fax +81 (45) 478-2180
www.tps.co.jp

Latin America
Tel 1-305-428-5210
Fax 1-305-717-4909
www.elotouch.com.ar

Revision B
P/N E071795

For current Elo news, product updates and announcements, register to receive our TouchMonitor newsletter at www.elotouch.com/go/news



Tyco Electronics

Our commitment. Your advantage.