



Quick Installation Guide

Installing additional RAM for the 17A2/15A2



www.elotouch.com

North America
Elo TouchSystem
301 Constitution Drive,
Menlo Park, CA 94025
www.elotouch.com

Elo Technical Support
Online self-help:
www.elotouch.com/go/websupport
Technical Support contacts in your region:
www.elotouch.com/go/contactsupport

Europe
Tel +32 (0)16 35 21 00
Fax +32 (0)16 35 21 01
elosales@elotouch.com

Asia-Pacific
Tel +81 (45) 478-2161
Fax +81 (45) 478-2180
www.tps.co.jp

Revision B
P/N E065273

Latin America
Tel 1-305-428-5210
Fax 1-305-717-4909
www.elotouch.com.ar



Tyco Electronics

Our commitment. Your advantage.

- Note:**
- Always handle the component by its edges.
 - Installer must be electrically grounded while performing installation steps.

Note on adding/removing memory modules:

Be careful, as improper installation or removal of a memory module can cause harmful damage to your touchcomputer. Only install memory modules that are compatible with your touchcomputer. The module packaged with this accessory kit meets the requirements for this touchcomputer. Be careful when handling a memory module, as ESD can damage the module.



1 Turn off power to the touchcomputer and unplug the power adapter from the unit.



2 Turn touchcomputer upside down and take off the back cover insert

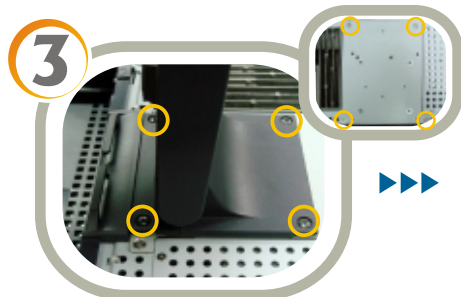

3 Remove the four screws connecting the stand to the chassis. Once these screws are removed, the stand will come off. Then remove the four screws on the chassis.

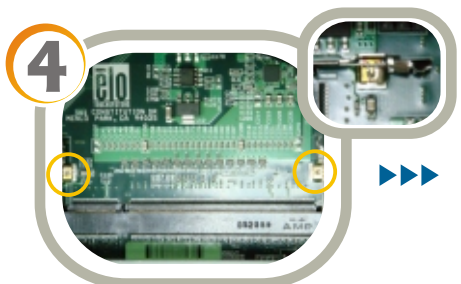

4 To remove an existing memory module, pull the two metal latches away from the modules until the module is released. The module should tilt up and then can be safely removed.



5 Align the pins of the memory module with the connector at an angle and push it in until the pins are in place. Then push the memory module down until it clicks. If it clicks, then it means the module was installed successfully.

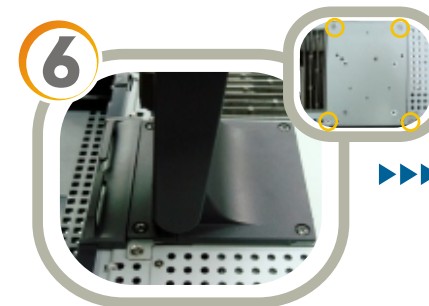

6 Reinstall the four screws to close the chassis and then reinstall the stand using the screws removed in Step 3.

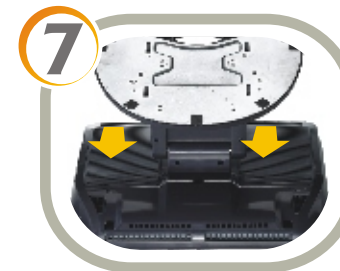

7 Replace the back cover insert.



8 Reconnect the power adapter and power on the touchcomputer. You may use the operating system to verify that the additional memory was installed properly.