

9



▶▶▶ Replace the front door.

10



▶▶▶ Replace the side door.

11



▶▶▶ Turn on the touchcomputer.

**Included Items:**

- Fingerprint reader module (includes cable with USB Type-A connector)
- Two screws to attach module to chassis

Note: For the D-Series touchcomputer, the software for the field-installable peripherals is already pre-installed.



# Quick Installation Guide

## Installing the Fingerprint Reader (FPR) for the D-Series Touchcomputer

Caution:  
Before attaching the fingerprint reader, make sure that the touchcomputer is powered off.

© 2009 Tyco Electronics.



[www.elotouch.com](http://www.elotouch.com)



Revision A  
P/N E924688

**North America**  
Elo TouchSystem  
301 Constitution Drive,  
Menlo Park, CA 94025  
[www.elotouch.com](http://www.elotouch.com)

**Elo Technical Support**  
**Online self-help:**  
[www.elotouch.com/go/websupport](http://www.elotouch.com/go/websupport)  
**Technical Support contacts in your region:**  
[www.elotouch.com/go/contactsupport](http://www.elotouch.com/go/contactsupport)

**Europe**  
Tel +32 (0)16 35 21 00  
Fax +32 (0)16 35 21 01  
[elosales@elotouch.com](mailto:elosales@elotouch.com)

**Asia-Pacific**  
Tel +81 (45) 478-2161  
Fax +81 (45) 478-2180  
[www.tps.co.jp](http://www.tps.co.jp)

**Latin America**  
Tel 1-305-428-5210  
Fax 1-305-717-4909  
[www.elotouch.com.ar](http://www.elotouch.com.ar)



**Tyco Electronics**

Our commitment. Your advantage.



▶▶▶ Turn off the power to the touchcomputer.



▶▶▶ Remove the side door, as shown.



▶▶▶ Remove the front door.

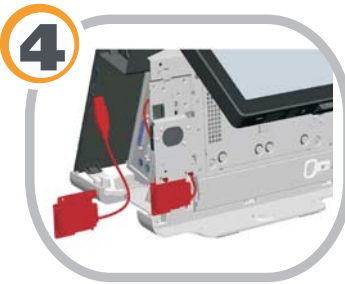

▶▶▶ Insert the fingerprint reader module into the chassis.



▶▶▶ Add two screws to hold it in place.



▶▶▶ Connect the USB cable to the USB connector.

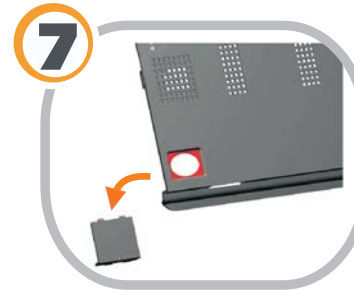

▶▶▶ Remove the existing cover from the front door on the left side.

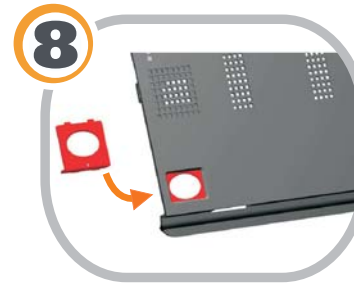

▶▶▶ Add the fingerprint reader cover.