

▶▶▶ Re-install the rear cover and tighten the thumb screws.

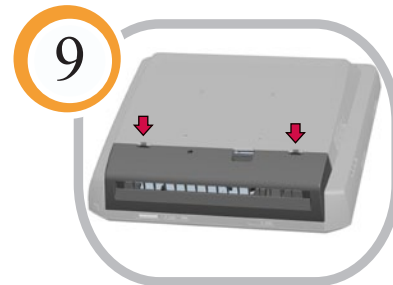

▶▶▶ Re-install the cable cover.

- Included Items:
- One parallel port card

Additional Notes: Installation of this peripheral requires installation of PCIeXI adaptor kit (P/N E827958)



Quick Installation Guide

Installing the parallel port card for the B-Series Touchcomputer

Caution:
The touch computer must be unplugged before any installation occurs.



www.elotouch.com



Revision 1
P/N E130452

North America
Elo Touchsystems
301 Constitution Drive
Menlo Park, CA 94025
www.elotouch.com

Elo Technical Support
Online self-help:
www.elotouch.com/go/websupport
Technical Support contacts in your region:
www.elotouch.com/go/contactsupport

Europe
Tel +32 (0)16 35 21 00
Fax +32 (0)16 35 21 01
elosales@elotouch.com

Asia-Pacific
Tel +81 (45) 478-2161
Fax +81 (45) 478-2180
www.tps.co.jp

Latin America
Tel 1-305-428-5210
Fax 1-305-717-4909
www.elotouch.com.ar

Elo (logo), Elo TouchSystems, TE (logo) and Tyco Electronics are trademarks of the Tyco Electronics group of companies and its licensors.



Tyco Electronics
Our commitment. Your advantage.

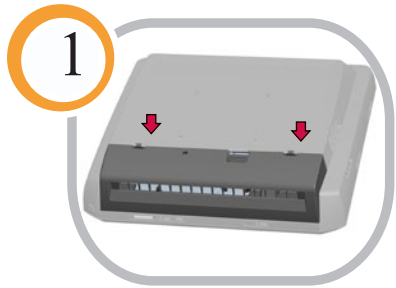

▶▶▶ Remove the cable cover.

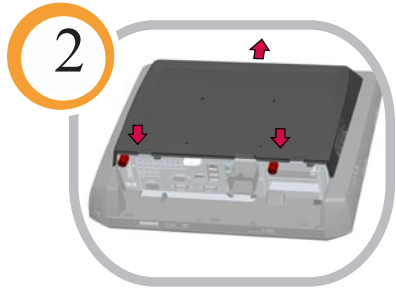

▶▶▶ Remove the rear cover by unscrewing the two thumb screws and sliding the cover upward.

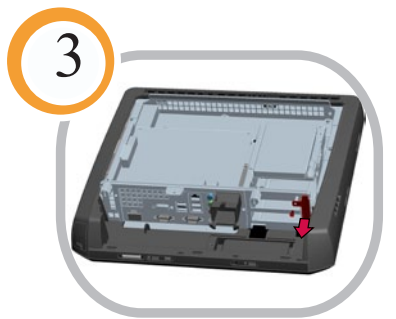

▶▶▶ Remove the PCI lock by unscrewing the mounting screw and pulling the lock upward.

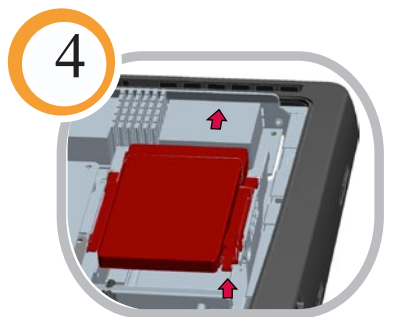

▶▶▶ Remove the primary hard drive (HDD1) by pulling up on the mounting latch and sliding it back.

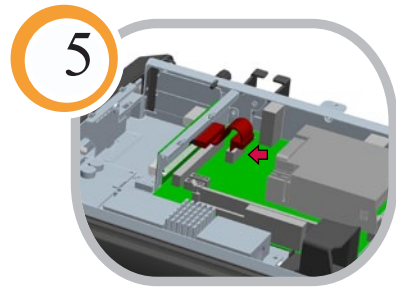

▶▶▶ Install the Elo PCIeXI adaptor kit (P/N E827958) if not already installed.

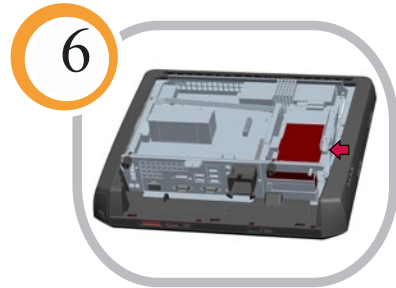

▶▶▶ Plug the parallel port card into the top PCI slot as shown.

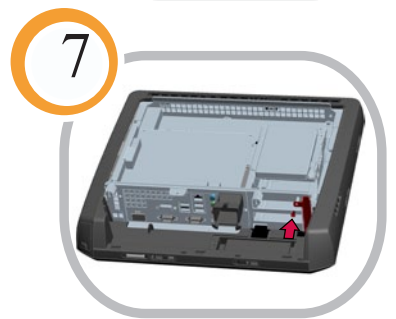

▶▶▶ Re-install the PCI lock and fasten it with the screw removed in STEP 3.

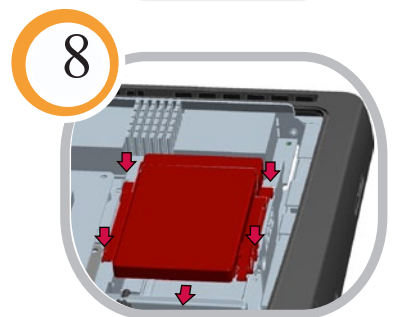

▶▶▶ Re-install the primary hard drive (HDD1) by inserting all four (4) of the hooks into the chassis holes and slide the drive forward.