

Quick Installation Guide

Installing the memory upgrade kit for the B-Series Touchcomputer

Caution:
The touch computer must be unplugged before any installation occurs.

- Included Items:
- One 8GBx128 pin DIMM module



www.elotouch.com



Revision A
P/N E919251

North America
Elo TouchSystem
301 Constitution Drive,
Merlo Park, CA 94025
www.elotouch.com

Elo Technical Support
Online self-help:
www.elotouch.com/go/websupport
Technical Support contacts in your region:
www.elotouch.com/go/contactsupport

Europe
Tel +32 (0)16 35 21 00
Fax +32 (0)16 35 21 01
elosales@elotouch.com

Asia-Pacific
Tel +81 (45) 478-2161
Fax +81 (45) 478-2180
www.jp.elotouch.com

Latin America
Tel 1-305-428-5210
Fax 1-305-717-4909
www.elotouch.com.ar



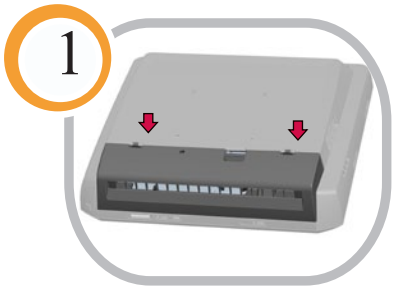

1

▶▶▶ Remove the cable cover.

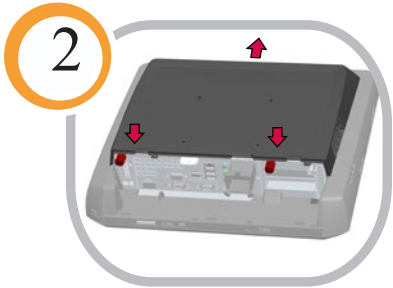

2

▶▶▶ Remove the rear cover by unscrewing the two thumb screws and sliding the cover upward.

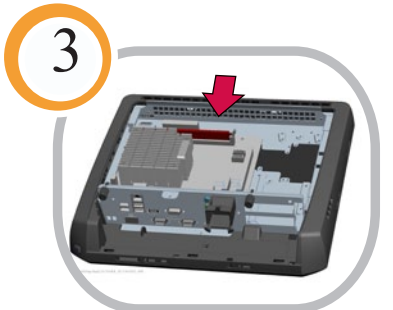

3

▶▶▶ Remove the existing memory located as shown at left and replace it with the module from the memory upgrade kit.

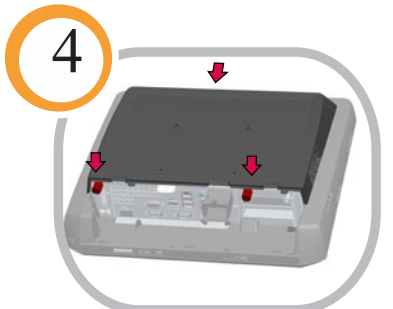

4

▶▶▶ Re-install the rear cover and tighten the thumb screws.

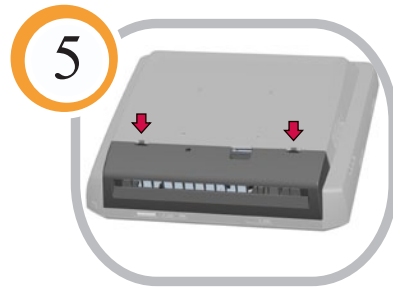

5

▶▶▶ Re-install the cable cover.