

▶▶▶ Re-install the rear cover and tighten the thumb screws.

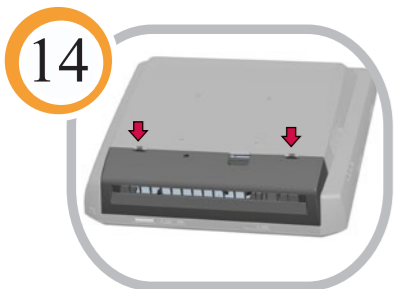

▶▶▶ Re-install the cable cover.

Included Items:

- One powered USB card
- Three internal USB cables

Additional Notes:



Quick Installation Guide

Installing the powered USB for the B-Series Touchcomputer

Caution:
The touch computer must be unplugged before any installation occurs.



www.elotouch.com



Revision A
P/N E109545

North America
Elo TouchSystem
301 Constitution Drive,
Menlo Park, CA 94025
www.elotouch.com

Elo Technical Support
Online self-help:
www.elotouch.com/go/websupport
Technical Support contacts in your region:
www.elotouch.com/go/contactsupport

Europe
Tel +32 (0)16 35 21 00
Fax +32 (0)16 35 21 01
elosales@elotouch.com

Asia-Pacific
Tel +81 (45) 478-2161
Fax +81 (45) 478-2180
www.tps.co.jp

Latin America
Tel 1-305-428-5210
Fax 1-305-717-4909
www.elotouch.com.ar



Tyco Electronics

Our commitment. Your advantage.

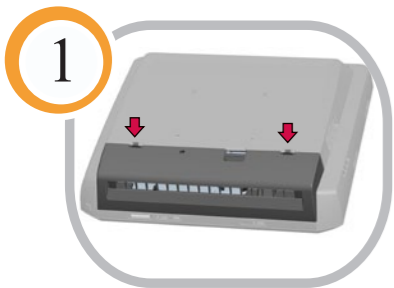

▶▶▶ Remove the cable cover.

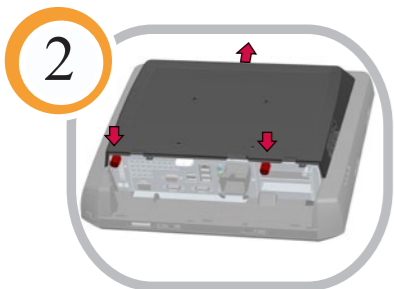

▶▶▶ Remove the rear cover by unscrewing the two thumb screws and sliding the cover upward.

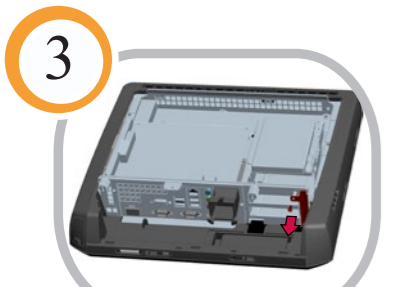

▶▶▶ Remove the PCI lock by unscrewing the mounting screw and pulling the lock upward.

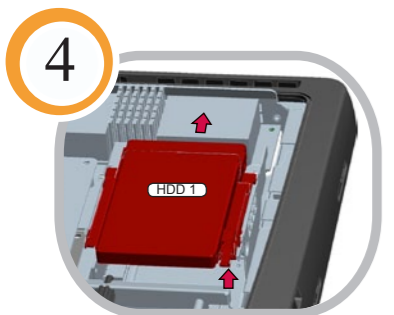

▶▶▶ Remove the primary hard drive (HDD1) by pulling up on the mounting latch and sliding it back.

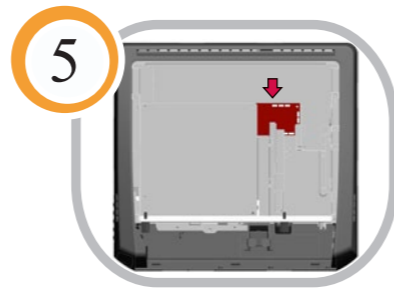

▶▶▶ Locate the touchcomputer USB hub as shown.

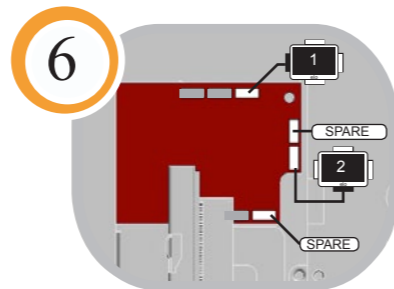

▶▶▶ The powered USB card requires three open USB connections on the USB hub. Note the location of the two spare connections and then unplug a third unused external accessory connection.

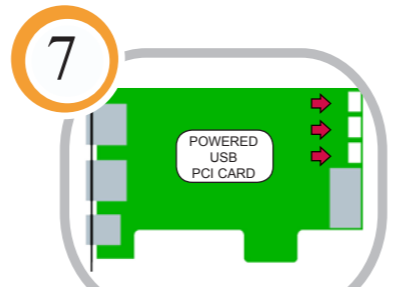

▶▶▶ Connect one end of the three included USB cables to the powered USB card connectors as shown. Do not connect the other ends until step 9.

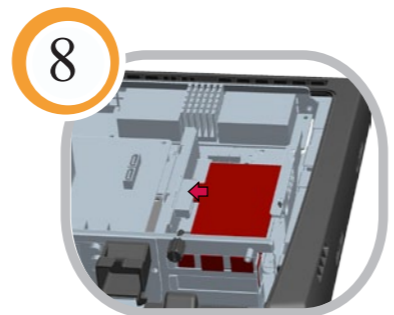

▶▶▶ Insert the powered USB card into the top PCI slot.

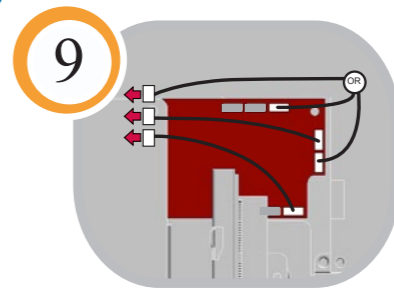

▶▶▶ Connect the three cables from the powered USB card to the touchcomputer USB hub. Use the connectors chosen in step 6.

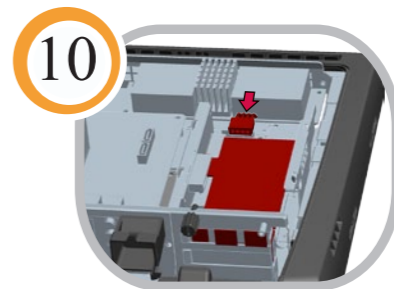

▶▶▶ Connect the power cable from the touchcomputer internal power supply to the powered USB card.

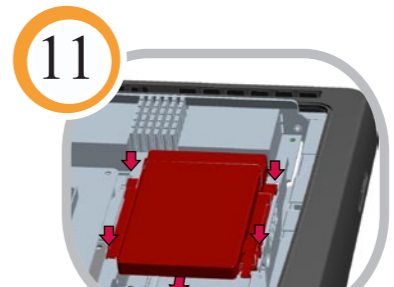

▶▶▶ Re-install the primary hard drive (HDD1) by inserting all four (4) of the hooks into the chassis holes and slide the drive forward.

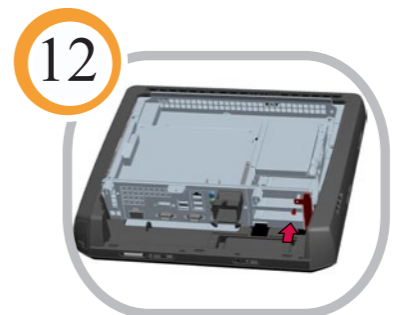

▶▶▶ Re-install the PCI lock and fasten it with the screw removed in STEP 3.