

NOTES:
 1. ALL DIMENSIONS +/- 1.0MM UNLESS NOTED
 2. DIMENSIONS SHOWN ARE FOR ALL TOUCH TECHNOLOGIES UNLESS NOTED.

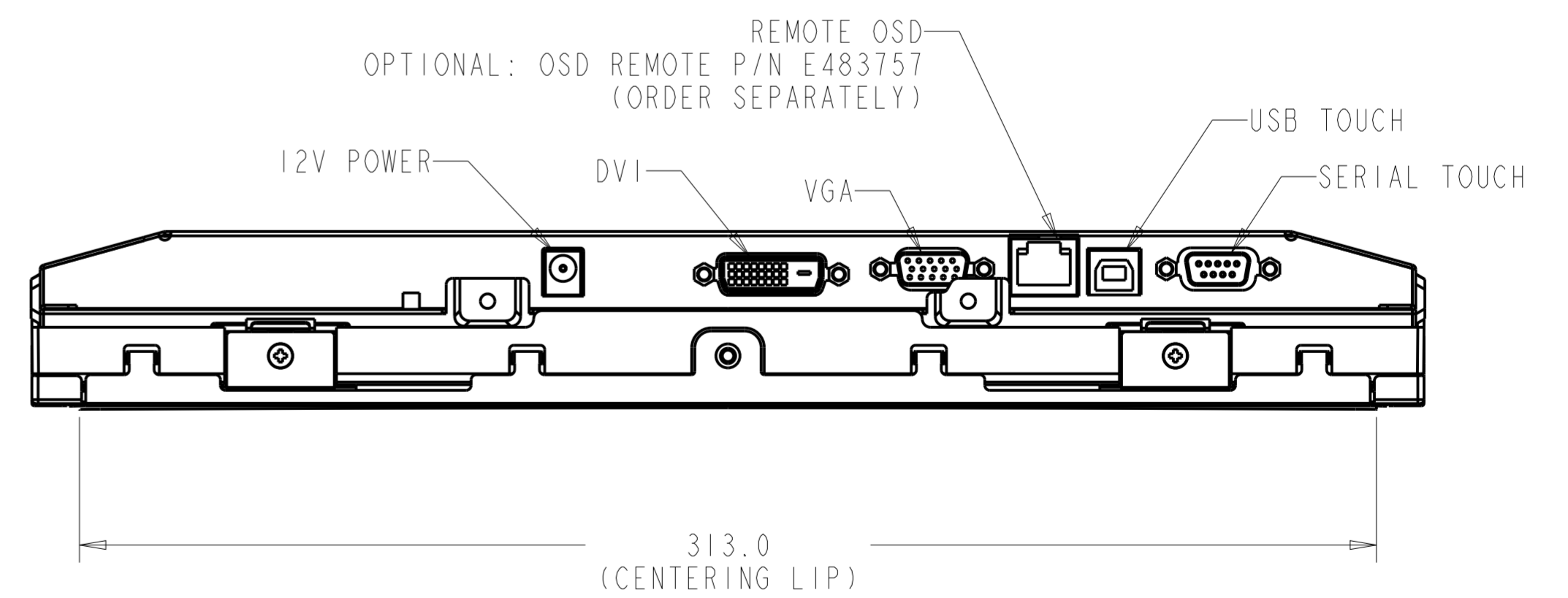

IR OPTION

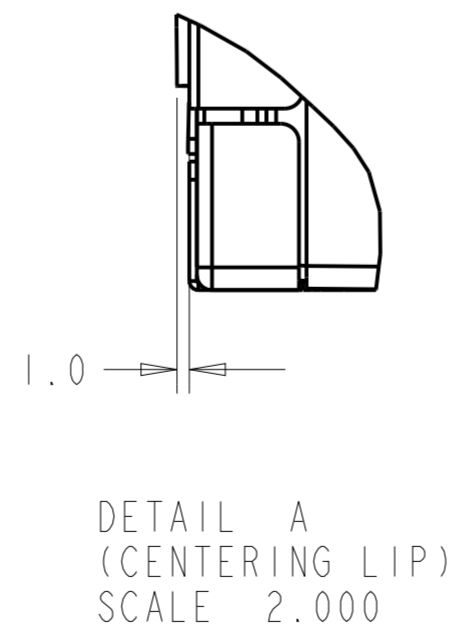
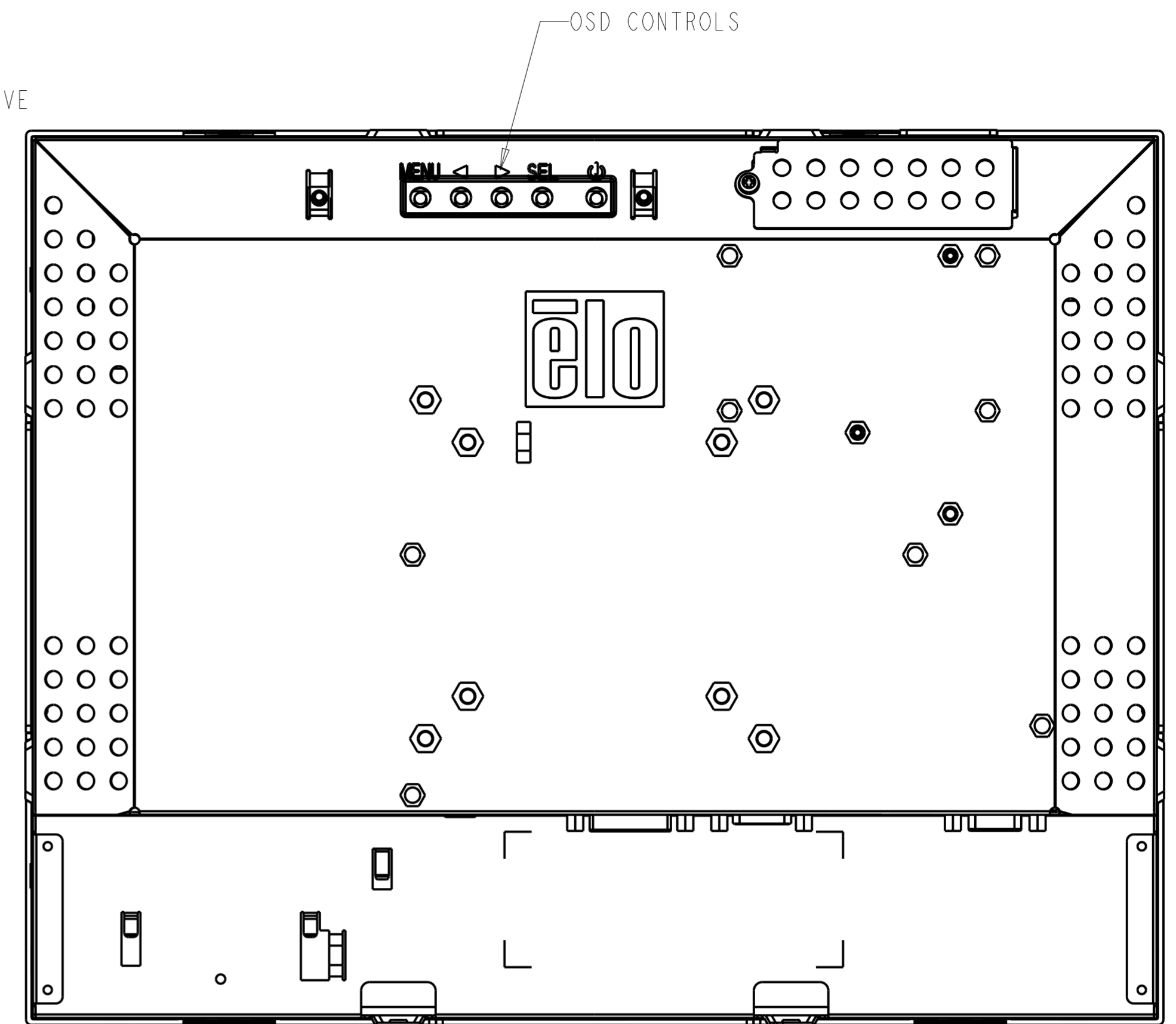
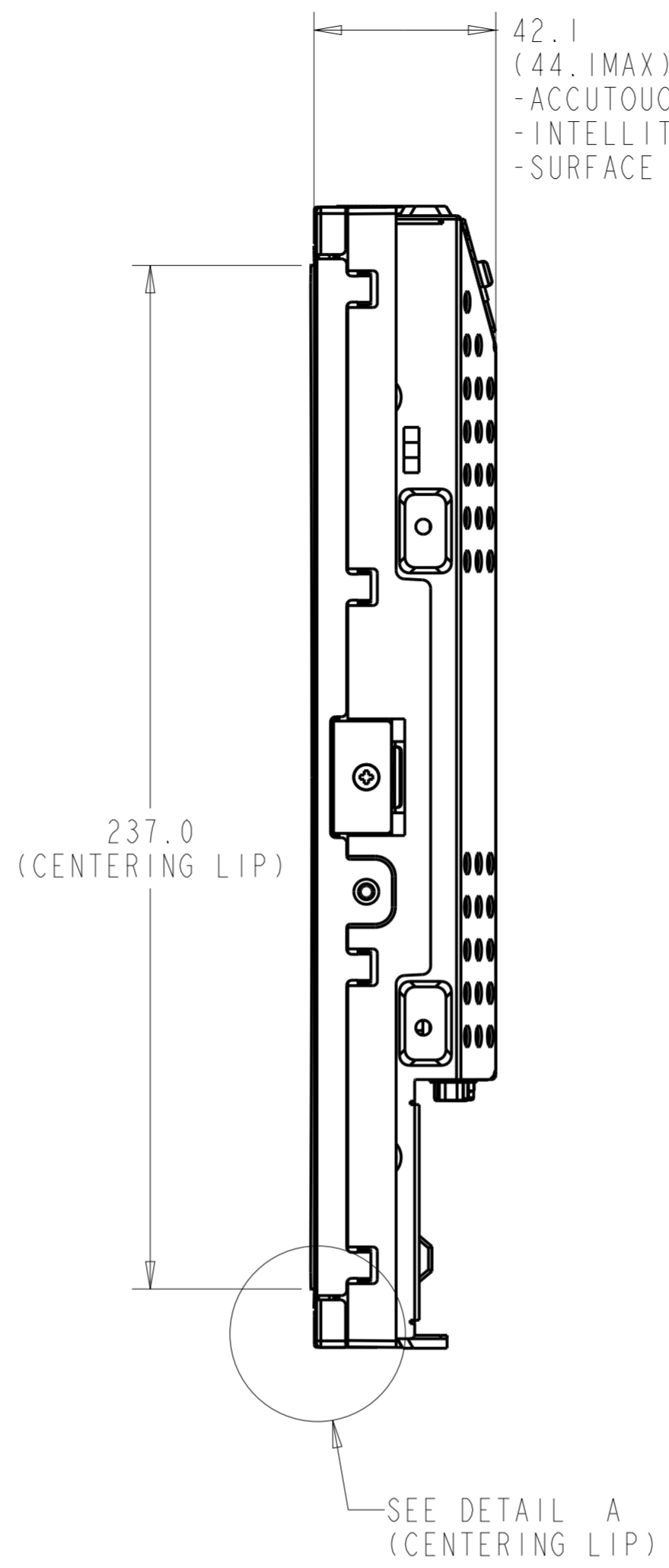
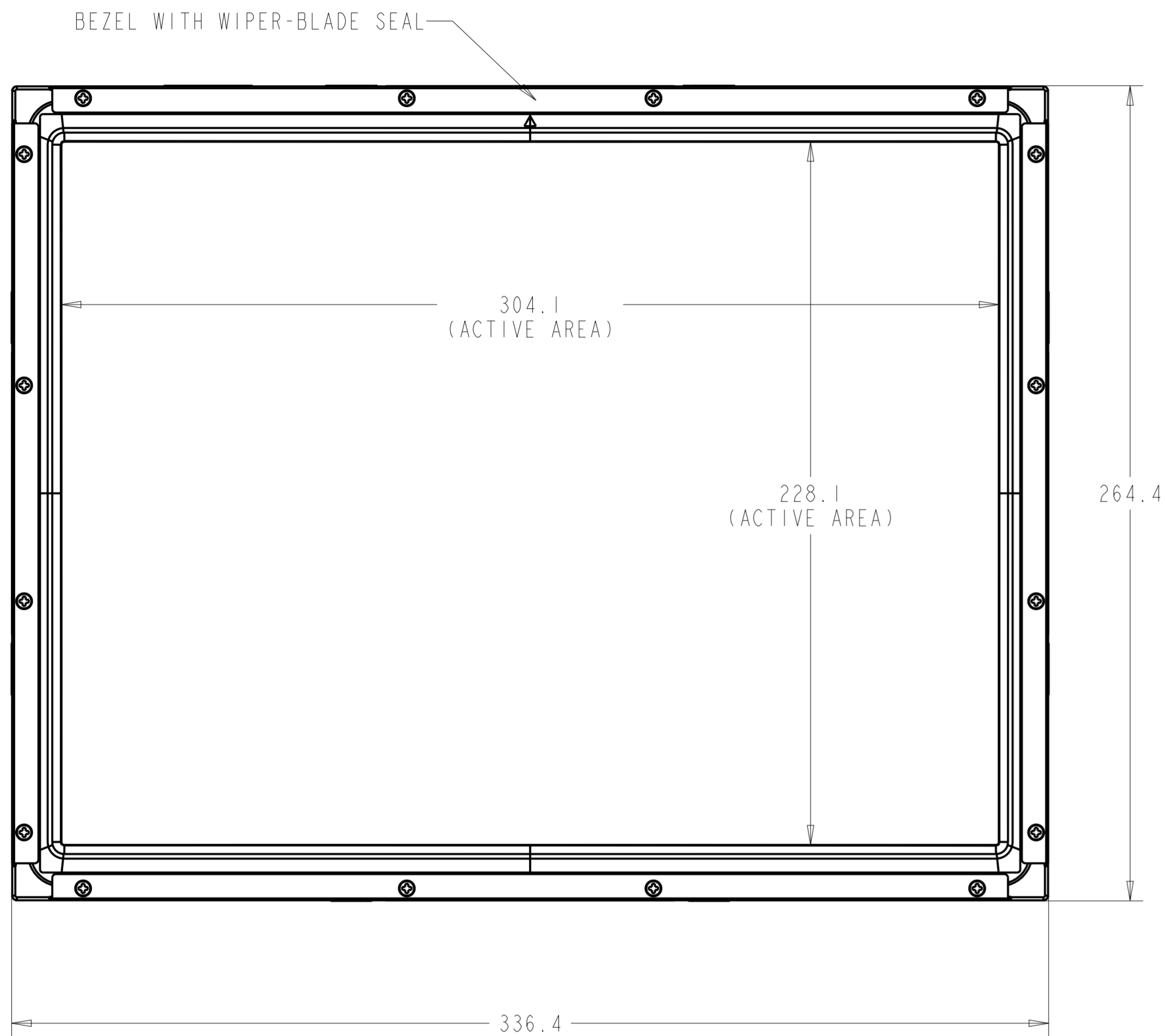
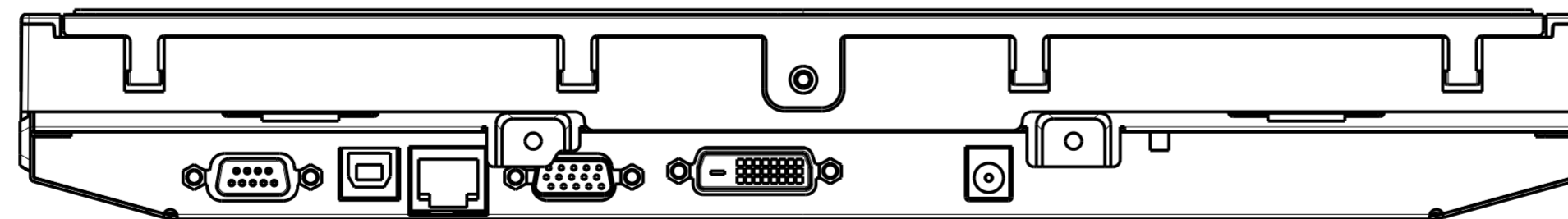
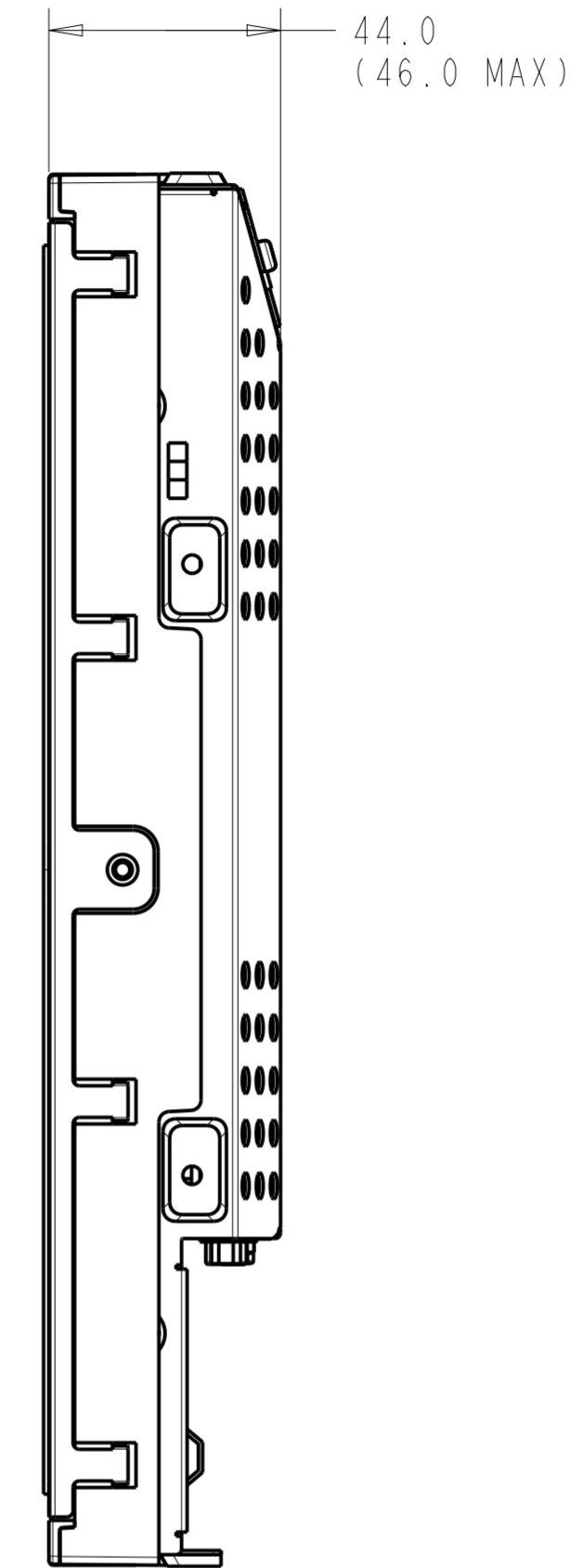
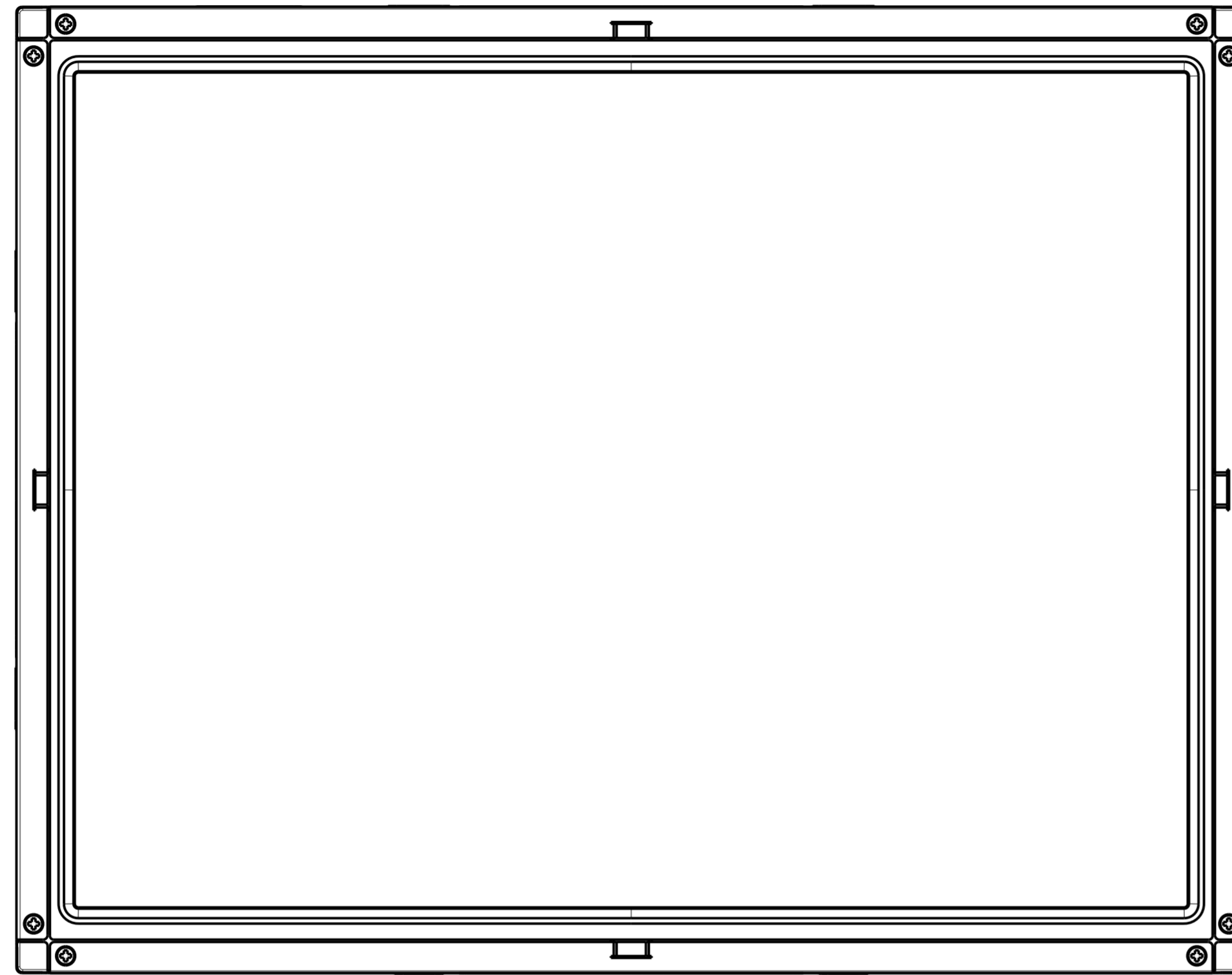

SECURETOUCH OPTION

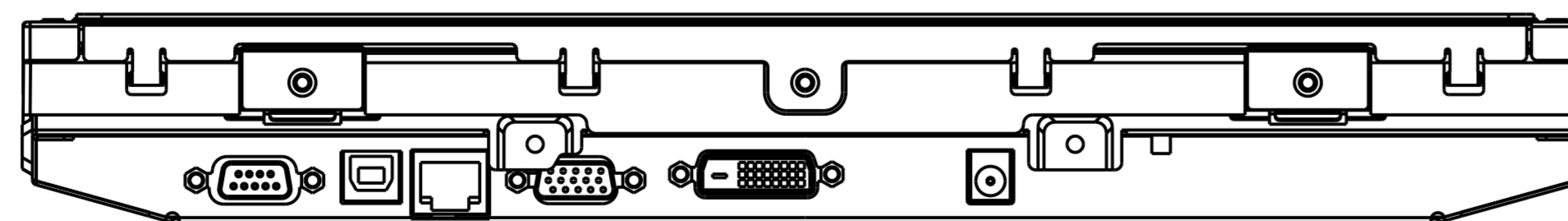
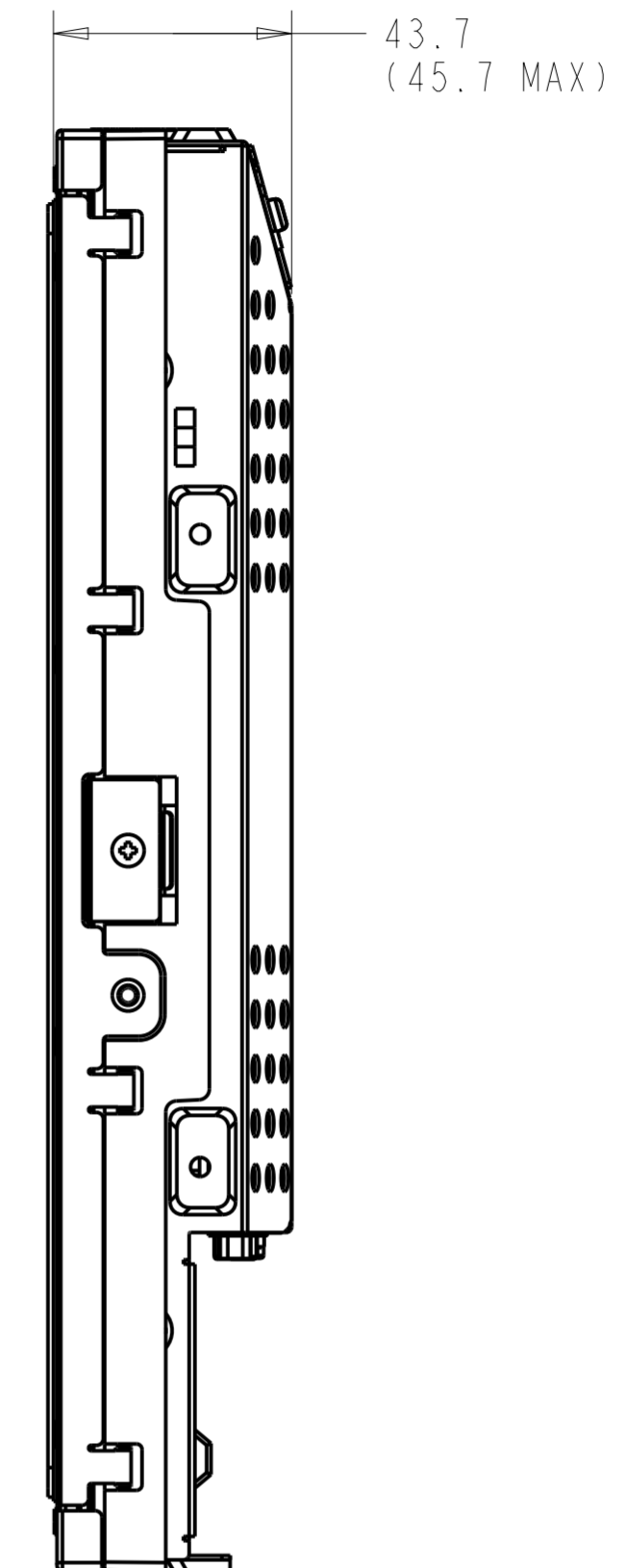
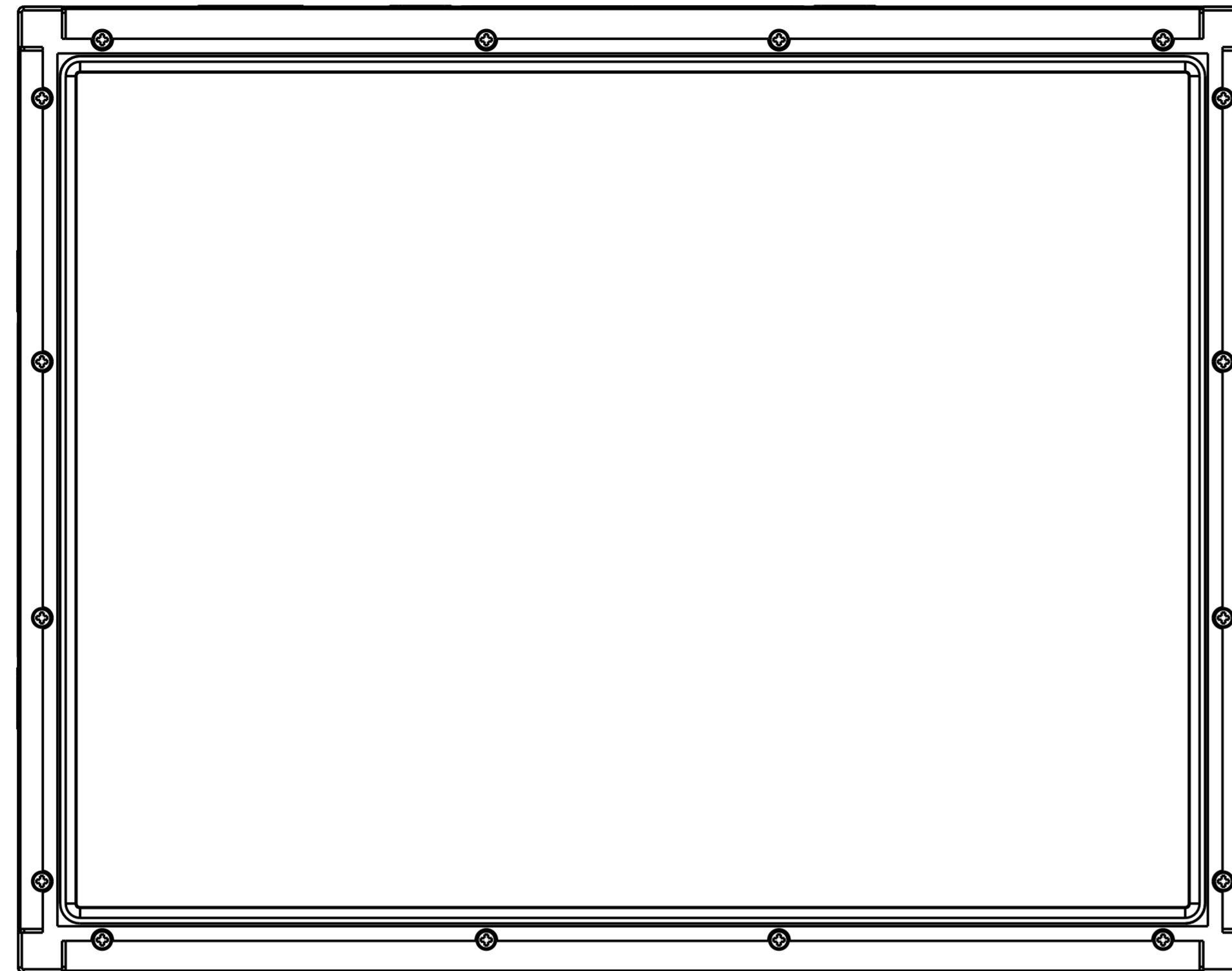

**RECOMMENDED CUSTOMER
PANEL CUT-OUT (SEE NOTE A)**

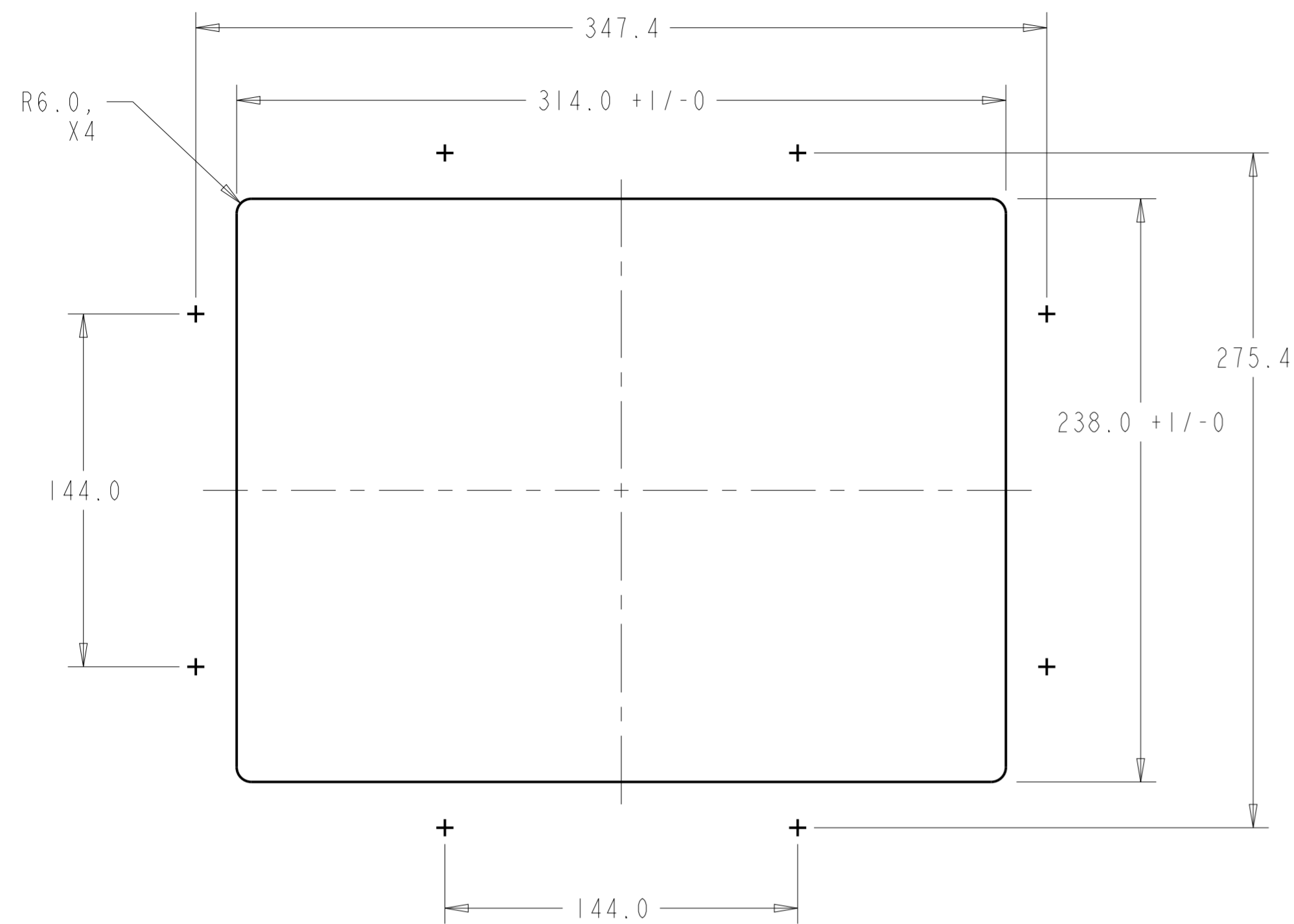

NOTE A
CUSTOMER PANEL MATERIAL:

1. WOOD: $\varnothing 4.5$ HOLES THRU FOR M4 SCREWS W/NUTS, OR, NO THRU HOLES, SCREWS FOR WOOD $\varnothing 4$ mm,

2. SHEET METAL: CONCEALED HEAD THREADED STUDS M4 W/NUTS.

NOTE B

MONITOR INCLUDES 2 BRACKETS, ADDITIONAL BRACKETS AVAILABLE, P/N E203787

NOTE C

27.2 mm = SECURE TOUCH AND IR

VESA MOUNT

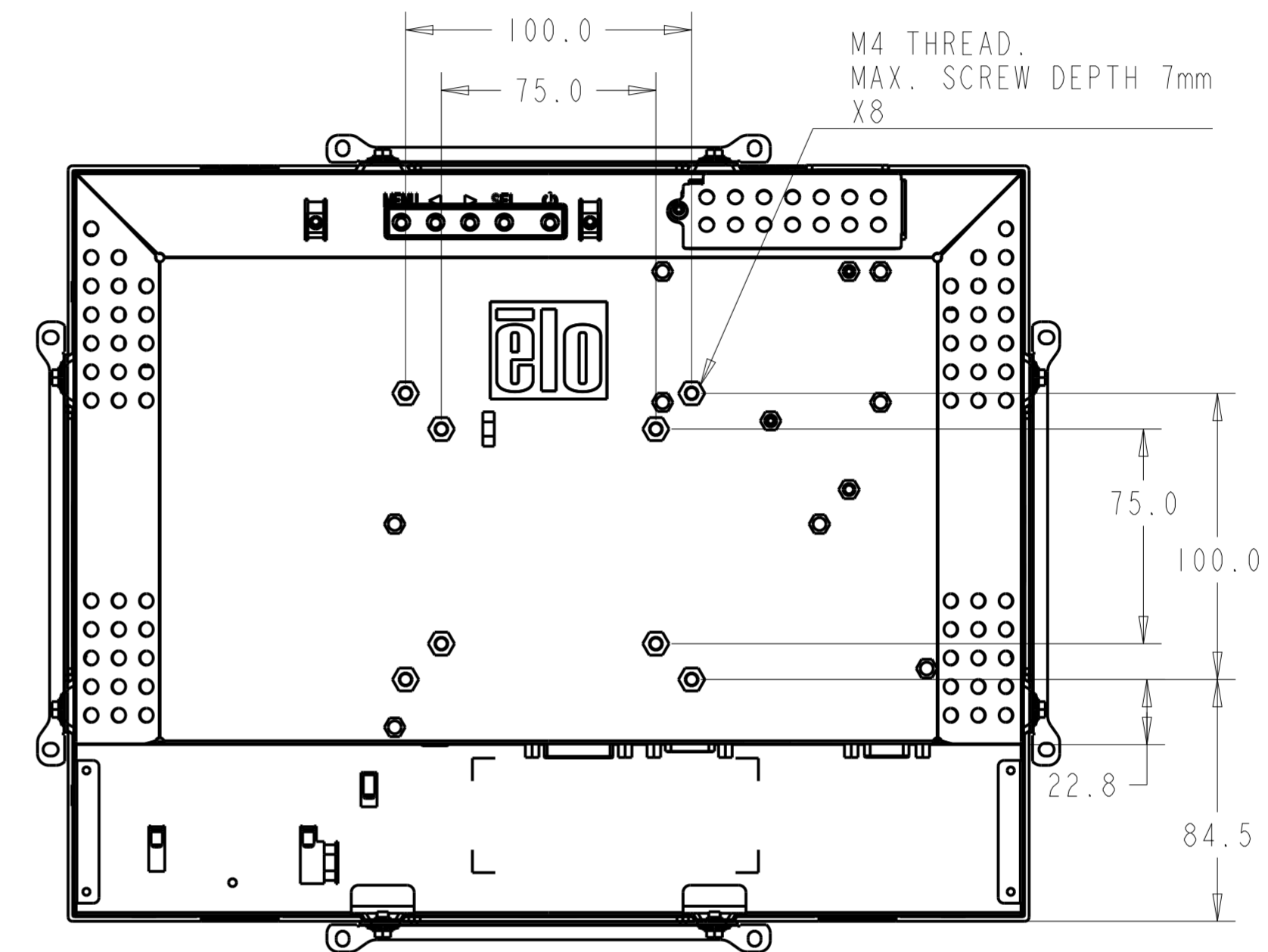

SIDE MOUNT, VERTICAL

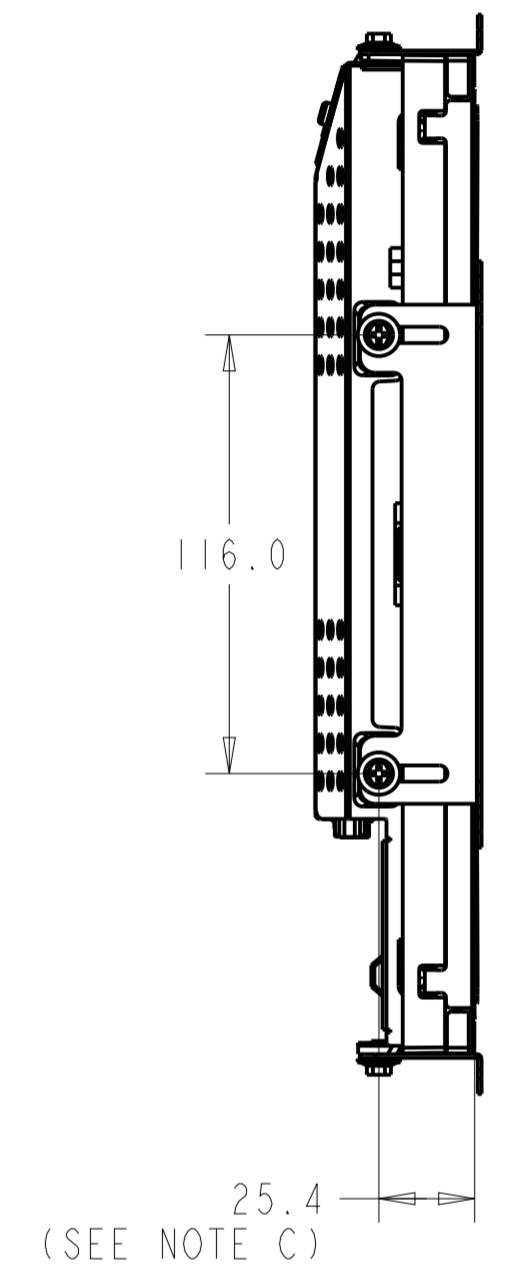

**REAR MOUNT WITH BRACKETS,
HORIZONTAL AND VERTICAL (SEE NOTE B)**

MOUNTING BRACKETS ACCOMMODATE MAX. 14mm MATERIAL THICKNESS.

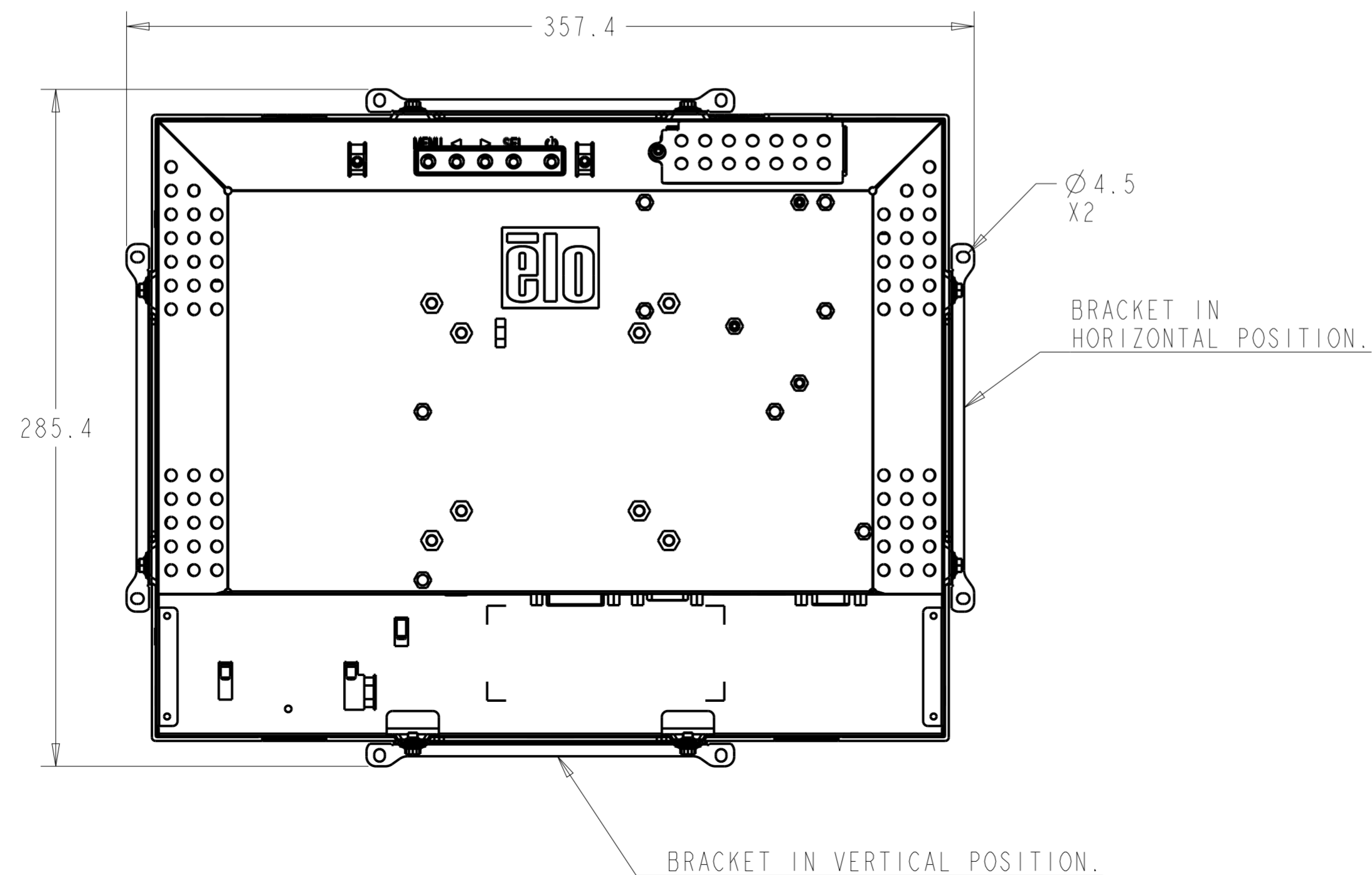
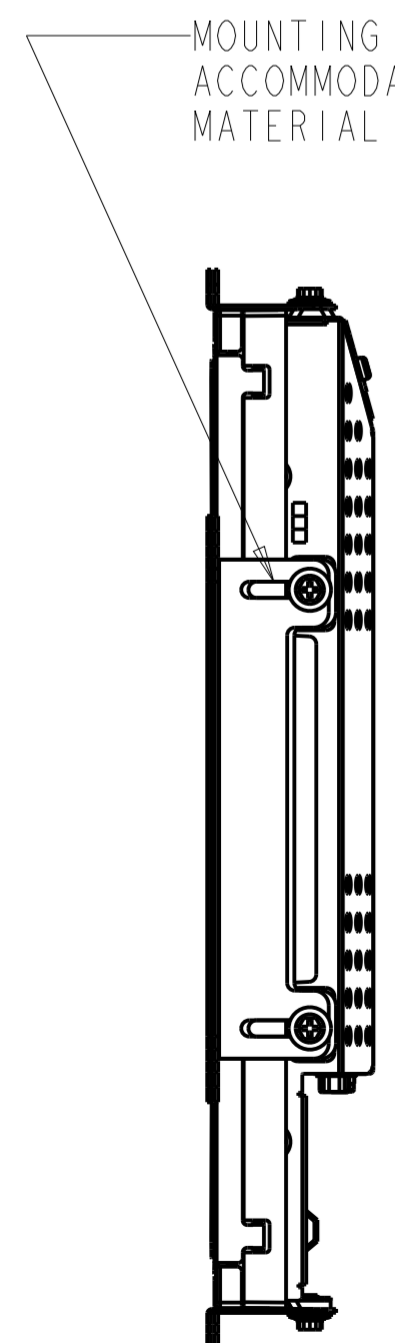

SIDE MOUNT, HORIZONTAL

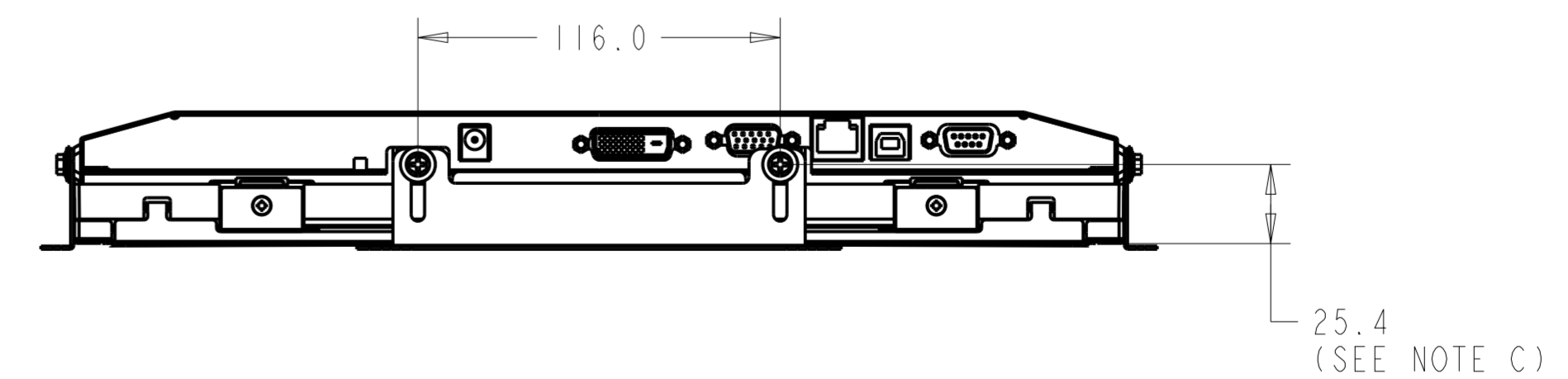

FRONT MOUNT OPTION

P/N E323425

(ORDERED SEPARATLY, CUSTOMER ASSEMBLED)

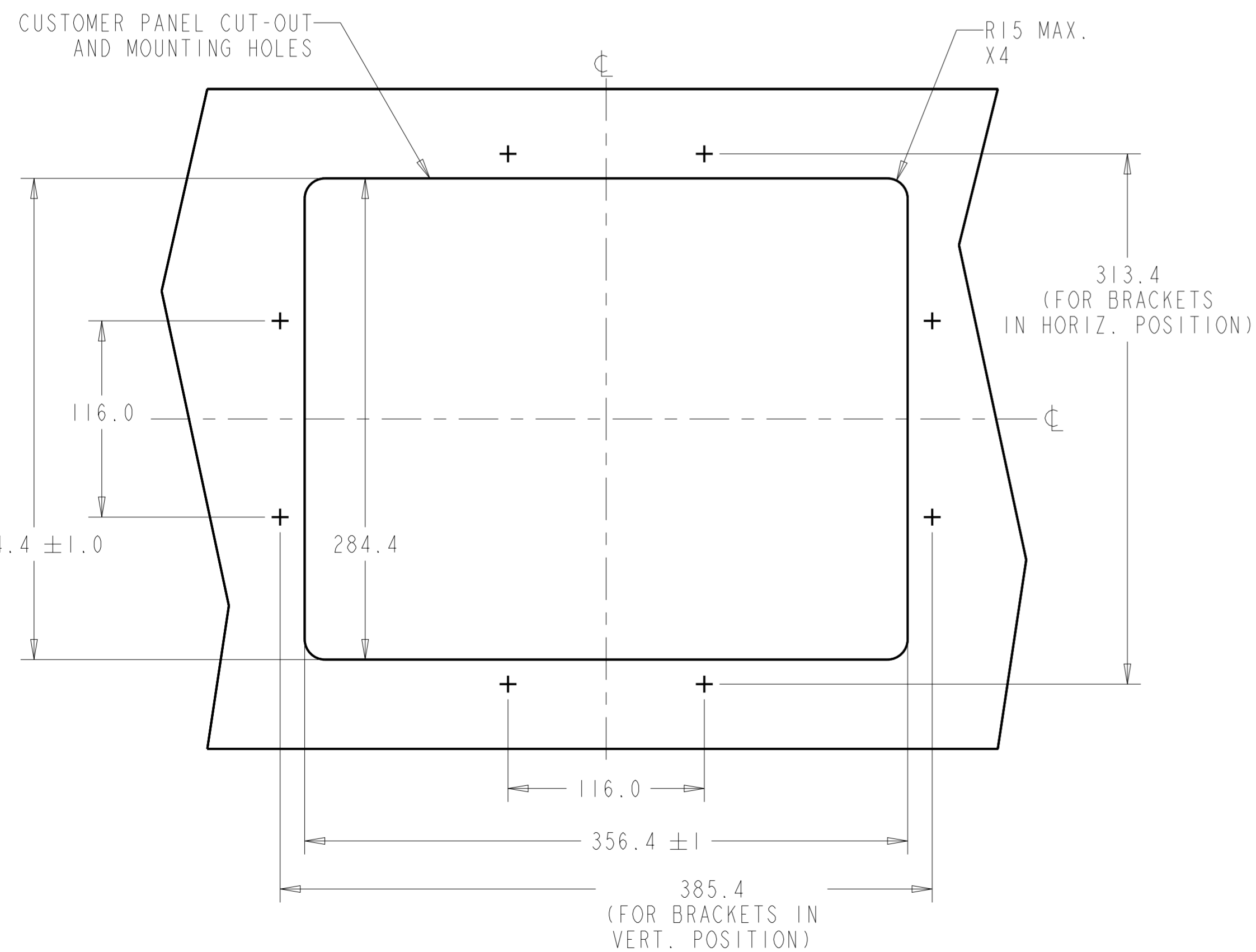
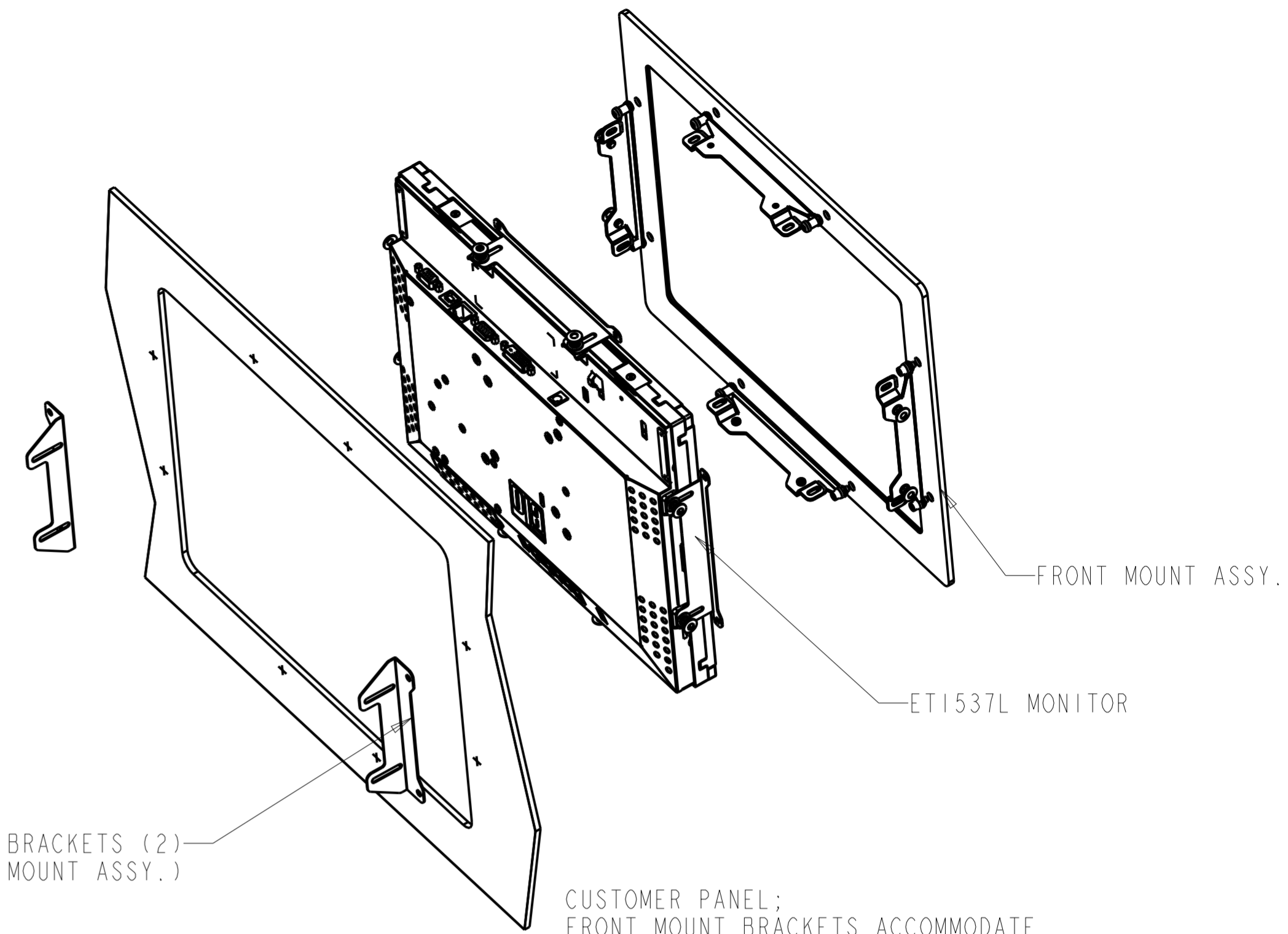
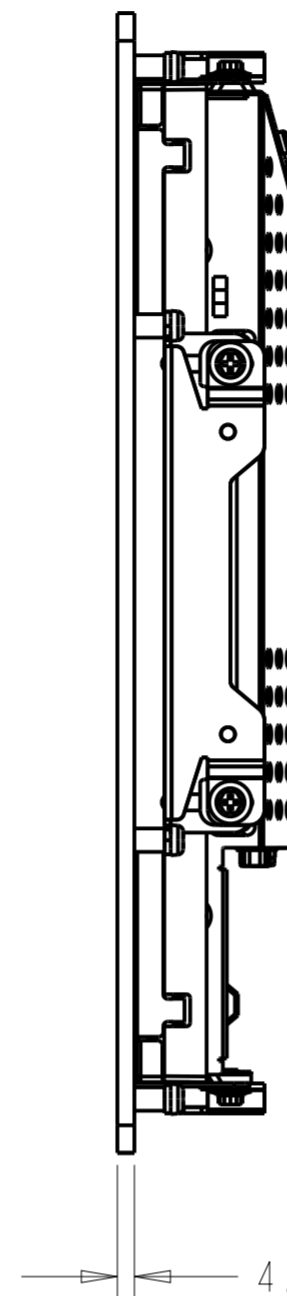
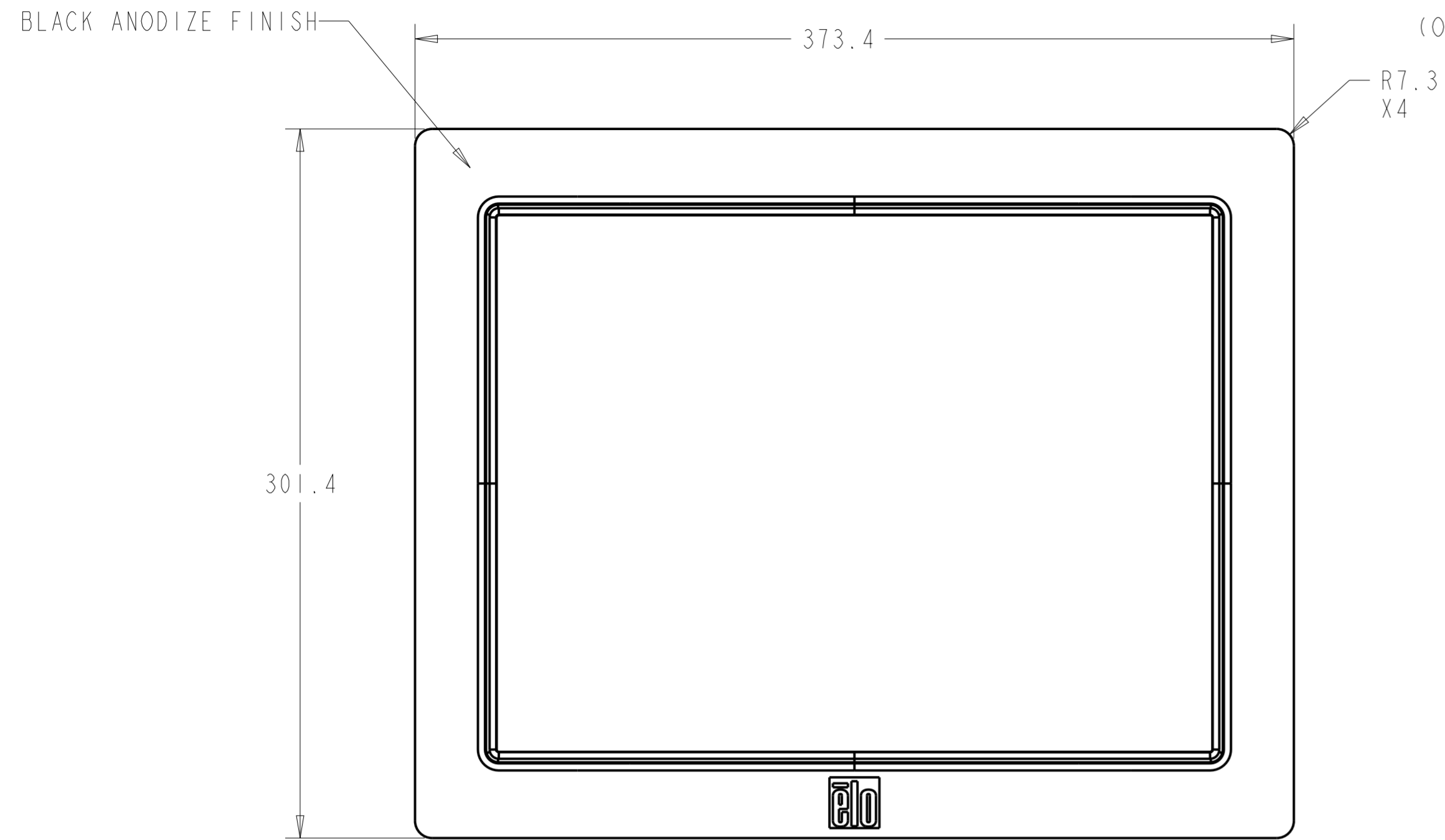

NOTE:

- IF CUSTOMER PANEL MATERIAL IS WOOD:
Ø4.5mm HOLES THRU FOR M4 SCREWS,
OR NO THRU HOLES, SCREWS FOR WOOD Ø4mm.
- IF CUSTOMER PANEL MATERIAL IS SHEET METAL:
CONCEALED HEAD THREADED STUDS M4 WITH NUTS.

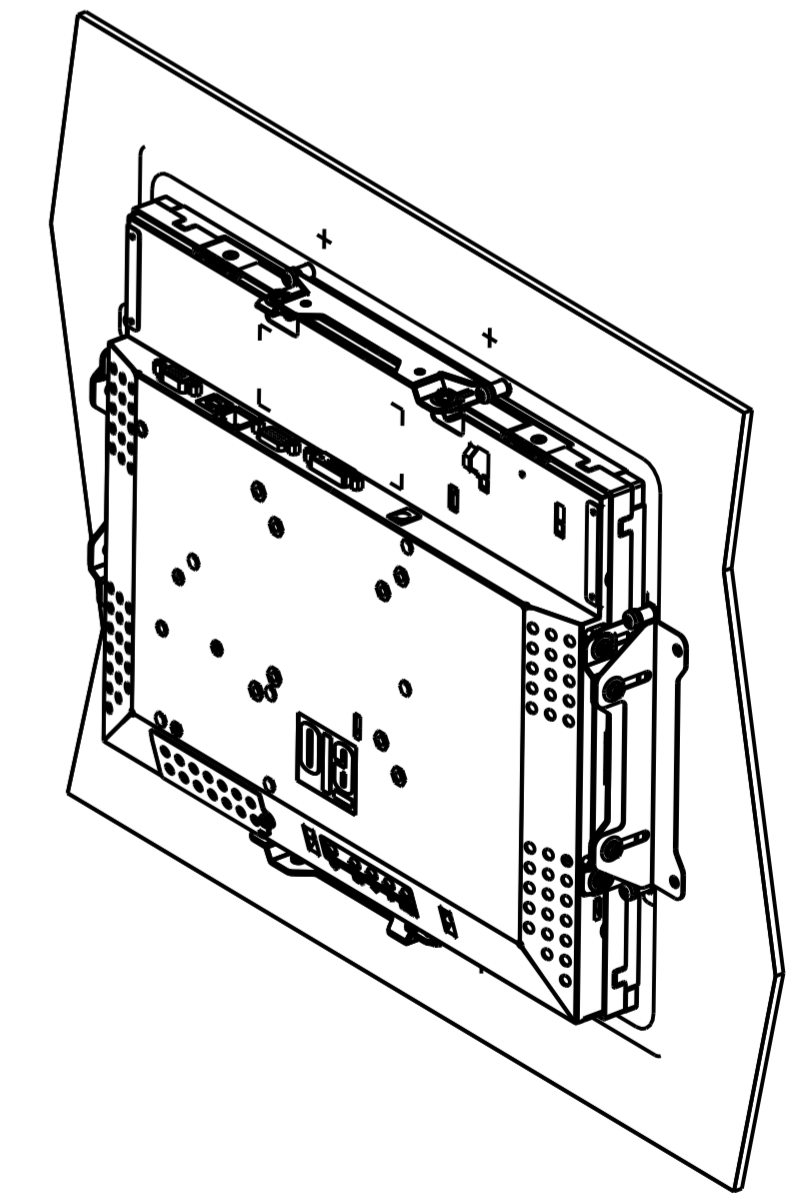
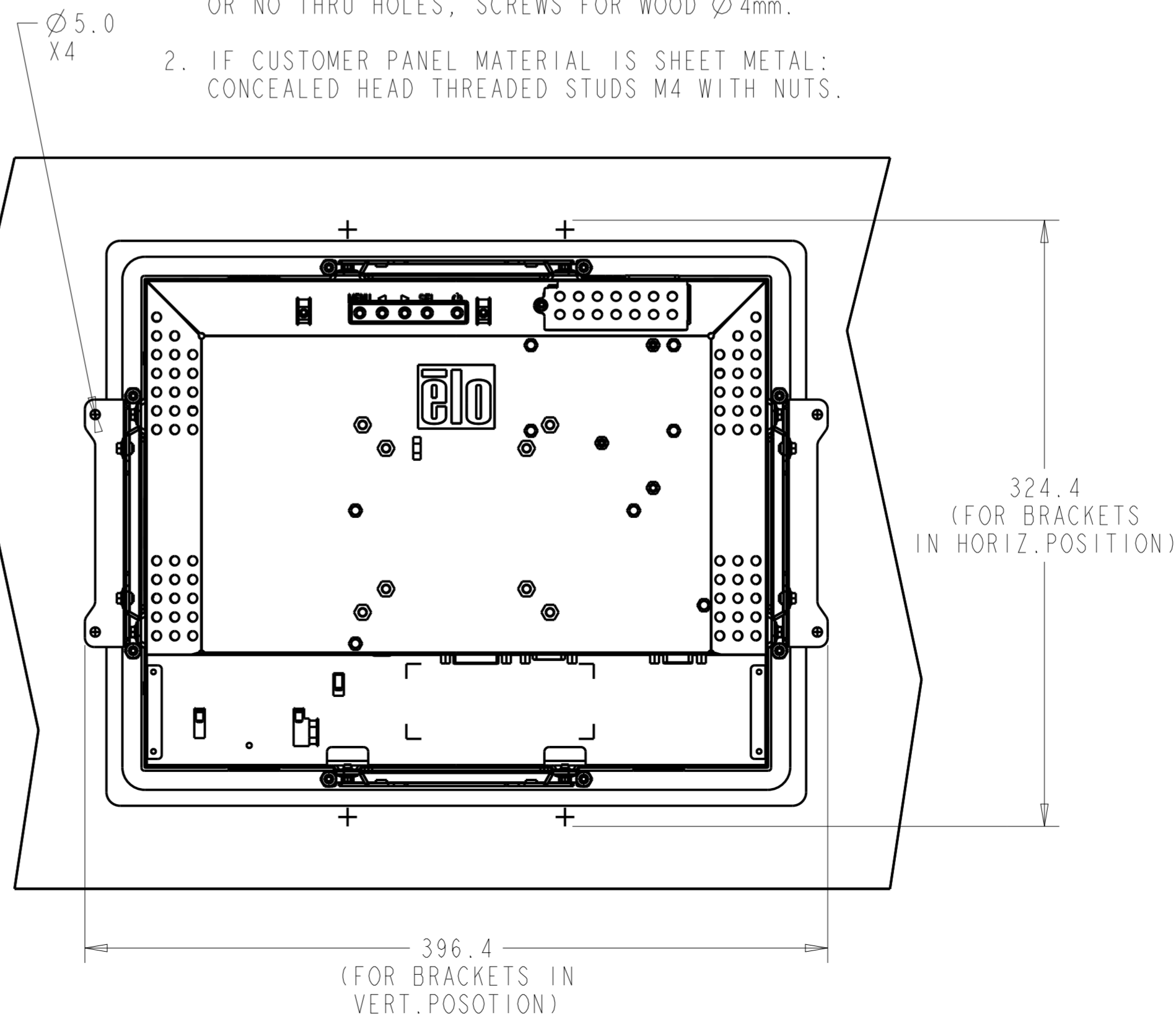

RACK MOUNT OPTION

P/N E295006

(ORDERED SEPERATLY, CUSTOMER ASSEMBLED)

BLACK ANODIZE

